



KRUGER BENSON ZIEMER ARCHITECTS, INC.
 1189 FELICIA ST., SUITE 105A VENTURA, CA 93001
 TELEPHONE (805) 654-1333

TODD A. JESPERSEN, AIA
 PRINCIPAL ARCHITECT
 JONATHAN D. LEE
 ARCHITECTURAL ASSISTANT

All ideas, design arrangements and plans indicated or represented by this drawing are owned by and are the property of Kruger-Benson-Ziemer, AIA, architect, and were created, edited and developed for use on, and in connection with, the specified project. None of such ideas, designs, arrangements or plans shall be used by or disclosed to any person, firm or corporation for any purpose whatsoever without the written permission of Kruger-Benson-Ziemer.

ARCHITECTS STAMP & SIGNATURE ENGINEERS STAMP & SIGNATURE



CORRELANT #F047408

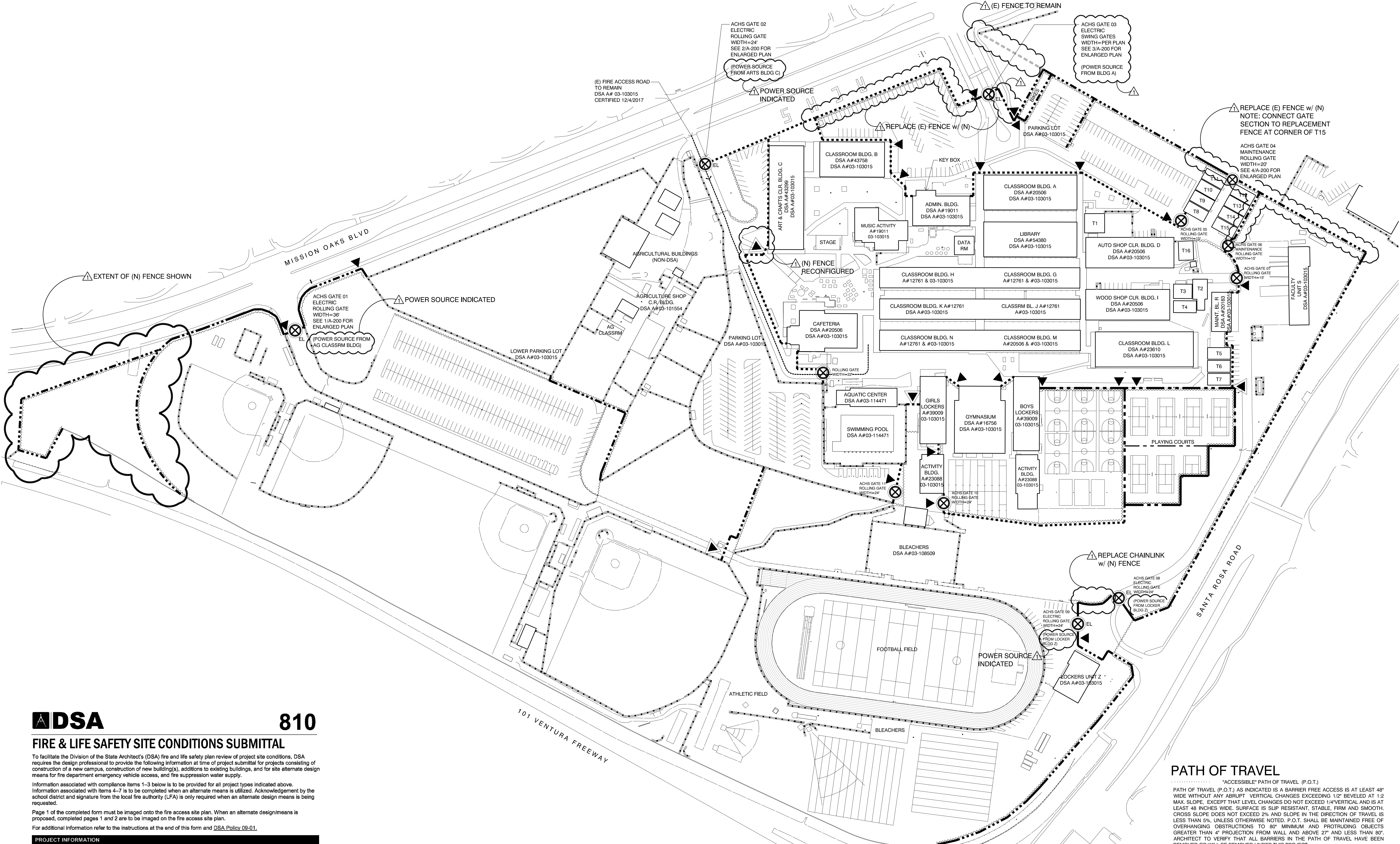

DSA 810
FIRE & LIFE SAFETY SITE CONDITIONS SUBMITTAL

To facilitate the Division of the State Architect's (DSA) fire and life safety plan review of project site conditions, DSA requires the design professional to provide the following information at time of project submittal for projects consisting of construction of a new campus, construction of new building(s), additions to existing buildings, and for site alternate design means for fire department emergency vehicle access, and fire suppression water supply.

Information associated with compliance items 1-3 below is to be provided for all project types indicated above. Information associated with items 4-7 is to be completed when an alternate means is utilized. Acknowledgement by the school district and signature from the local fire authority (LFA) is only required when an alternate design means is being requested.

Page 1 of the completed form must be imaged onto the fire access site plan. When an alternate design/means is proposed, completed pages 1 and 2 are to be imaged on the fire access site plan.

For additional information refer to the instructions at the end of this form and [DSA Policy 09-01](#).

PROJECT INFORMATION			
School District/Owner: Oxnard Union High School District			
Project Name/School: Campus Security Fencing at Adolfo Camarillo High School			
Project Address: 4660 Mission Oaks Blvd., Camarillo, CA 93012			
FIRE & LIFE SAFETY INFORMATION			
1. Has a fire hydrant flow test been performed within the past 12 months? (If yes, provide a copy of the test data.)	Yes <input type="checkbox"/>	No <input checked="" type="checkbox"/>	
2. Was the fire hydrant water flow test performed as part of this LFA review?	Yes <input type="checkbox"/>	No <input checked="" type="checkbox"/>	
3. Is the project located within a designated fire hazard severity zone as established by Cal-Fire? (If yes, indicate fire hazard zone classification below)	Yes <input type="checkbox"/>	No <input checked="" type="checkbox"/>	
Refer to the following for fire hazard zone locations: www.fire.ca.gov/fire_prevention/fire_prevention_wildland_zones_maps	Moderate <input type="checkbox"/>	High <input type="checkbox"/>	Very High <input type="checkbox"/>
Wildland Interface Area (WIFA) (If any designations are checked, project design must meet the requirements of CBC Chapter 7A.)	WIFA <input type="checkbox"/>		
CONDITION MEANS AND METHODS RESOLUTION			
	ALTERNATE ACCEPTED		
	Yes	No	N/A / N/R
4. Emergency vehicle access roadways do not meet CFC requirements.			<input checked="" type="checkbox"/>
4a. Acceptable Alternate: Emergency vehicle and personnel access as proposed by the project architect is acceptable for providing fire suppression and protection of life and property.			<input checked="" type="checkbox"/>
5. Fire Hydrants: Number and spacing does not meet CFC requirements.			<input checked="" type="checkbox"/>
5a. Acceptable Alternate: Number of fire hydrants and spacing as proposed by the project architect is acceptable for fire suppression and protection of life and property.			<input checked="" type="checkbox"/>
6. Fire Hydrants: Water flow and pressure are less than CFC minimum.			<input checked="" type="checkbox"/>
6a. Acceptable Alternate: The available flow and pressure is acceptable for providing fire suppression and protection of life and property.			<input checked="" type="checkbox"/>
7. Location of fire department connection(s) serving fire sprinkler systems or standpipe systems does not meet CFC requirements.			<input checked="" type="checkbox"/>
7a. Acceptable Alternate: The location of fire department connection serving the fire sprinkler system and/or standpipe system is acceptable for providing fire suppression and protection of life and property.			<input checked="" type="checkbox"/>

1 SITE PLAN (ADOLFO CAMARILLO HIGH SCHOOL)
 SCALE: 1" = 80'-0"

DSA 810
FIRE & LIFE SAFETY SITE CONDITIONS SUBMITTAL

School District Acceptance of Acceptable Design Alternates
 By signing this form, the school district acknowledges and accepts the proposed design as an alternative to California Building Code (CBC) and California Fire Code (CFC) minimum requirements, as indicated by one or more of the conditions indicated at items 4a, 5a, 6a or 7a, for providing fire and life safety protection of life and property.

Accepted by: _____ Title: _____
 Signature: _____ Date: _____

LOCAL FIRE AUTHORITY (LFA) INFORMATION
 LFA Agency Name: VENTURA COUNTY FIRE DEPARTMENT
 LFA Review Official: John Doda
 Title: FIRE INSPECTOR
 Work E-mail: John.Doda@ventura.org

NOTES:

- REPLACE IRRIGATION AS REQUIRED FOR INSTALLATION OF NEW FENCING.
- REFER TO PLAN FOR GATES THAT REQUIRE ELECTRIC OPENERS.
- POSTS: SQUARE TUBES 2-1/2" x 2-1/2" FORMED FROM NOMINAL THICKNESS, METALLIC-COATED STEEL SHEET OR FOR WED FROM .0625-INCH NOMINAL THICKNESS STEEL SHEET AND HOT DIP GALVANIZED AFTER FABRICATION.
- POSTS AT NON-ACCESSIBLE SWING GATE OPENINGS: SQUARE TUBES 3" x 2" FORMED FROM 0.108 INCH NOMINAL THICKNESS, METALLIC-COATED STEEL SHEET OR FORMED FROM 0.105 INCH NOMINAL THICKNESS STEEL SHEET AND HOT DIP GALVANIZED AFTER FABRICATION.
- POSTS AT ACCESSIBLE EGRESS GATE OPENINGS: SQUARE TUBES 4" x 4" FOR SINGLE-EGRESS OPENINGS AND 6" x 6" FOR DOUBLE-EGRESS OPENINGS.

FENCE LEGEND

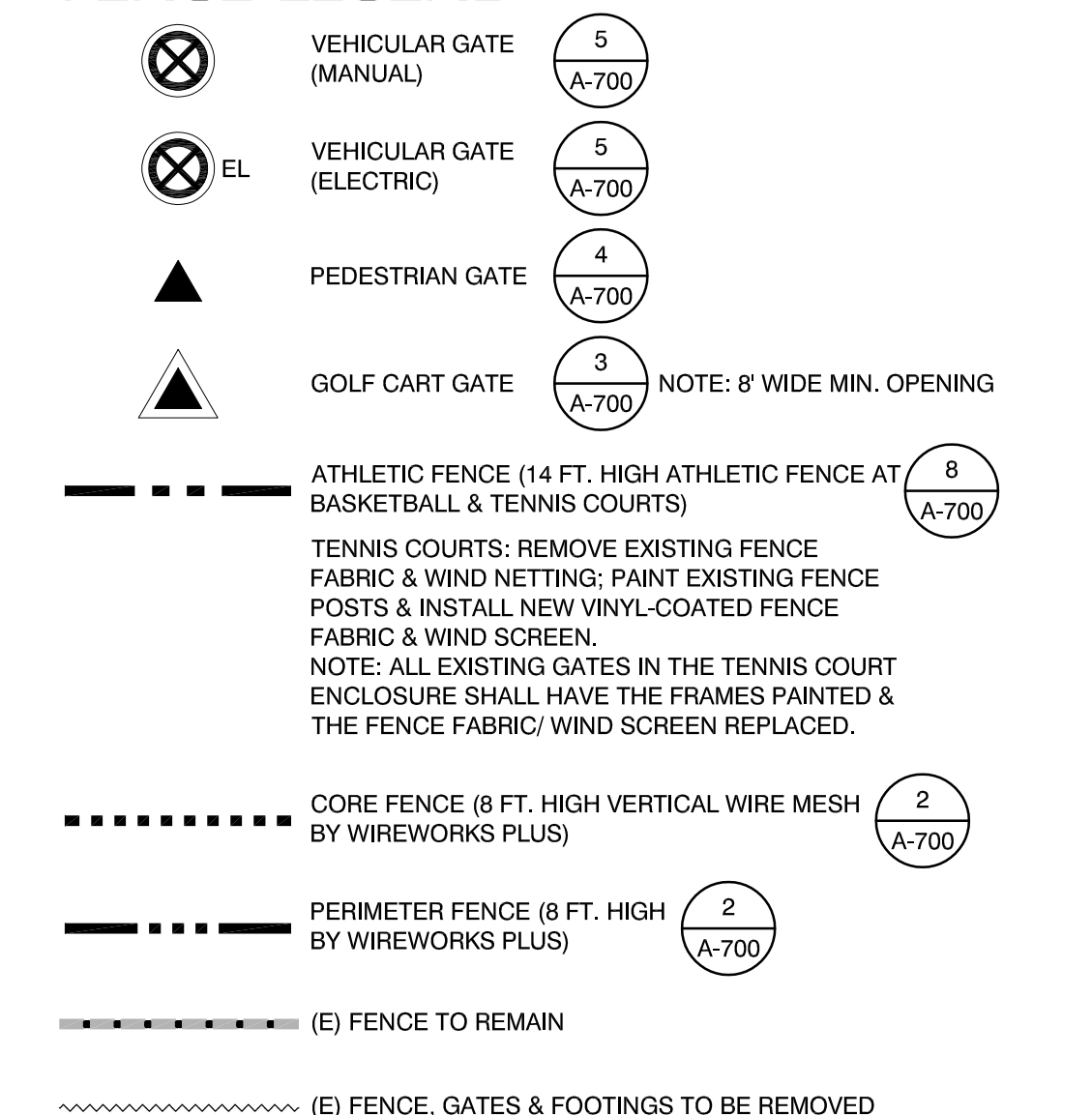

PATH OF TRAVEL

"ACCESSIBLE" PATH OF TRAVEL (P.O.T.)
 PATH OF TRAVEL (P.O.T.) AS INDICATED IS A BARRIER FREE ACCESS IS AT LEAST 48" WIDE WITHOUT ANY ABRUPT VERTICAL CHANGES EXCEEDING 1/2" BEVELED AT 1:2 MAX. SLOPE. EXCEPT THAT LEVEL CHANGES DO NOT EXCEED 1/4" VERTICAL AND IS AT LEAST 48 INCHES WIDE. SURFACE IS SLIP RESISTANT, STABLE, FIRM AND SMOOTH. CROSS SLOPE DOES NOT EXCEED 2% AND SLOPE IN THE DIRECTION OF TRAVEL IS LESS THAN 5% UNLESS OTHERWISE NOTED. P.O.T. SHALL BE MAINTAINED FREE OF OVERHANGING OBSTRUCTIONS TO 80" MINIMUM AND PROTRUDING OBJECTS GREATER THAN 4" PROJECTION FROM WALL AND ABOVE 27" AND LESS THAN 80" ARCHITECT TO VERIFY THAT ALL BARRIERS IN THE PATH OF TRAVEL HAVE BEEN REMOVED OR WILL BE REMOVED UNDER THIS PROJECT.

PATH OF TRAVEL (POT) AS VERIFIED BY ARCHITECT IS:

- A COMMON BARRIER FREE ACCESSIBLE ROUTE AT LEAST 48" WIDE WITHOUT ANY ABRUPT VERTICAL CHANGES EXCEEDING 1/2" BEVELED AT 1:2 MAXIMUM SLOPE, EXCEPT THAT LEVEL CHANGES DO NOT EXCEED 1/4" VERTICAL.
- THE PATH SURFACE IS SLIP RESISTANT, STABLE, FIRM, AND SMOOTH.
- PASSING SPACES AT LEAST 60" x 60" ARE LOCATED NOT MORE THAN 200' APART.
- CONTINUOUS GRADIENTS HAVE 60" LEVEL AREAS NOT MORE THAN 400' APART.
- CROSS-SLOPE DOES NOT EXCEED 2%.
- SLOPE IN THE DIRECTION OF TRAVEL IS LESS THAN 5% UNLESS OTHERWISE INDICATED AS A RAMP.
- MAINTAIN POT FREE OF OVERHANGING OBSTRUCTIONS TO 80" MINIMUM. PROTRUDING OBJECTS GREATER THAN 4" PROJECTION FROM WALL OR EDGE AND 27" ABOVE FINISH GRADE.

FOR GRATINGS LOCATED IN THE SURFACE OF ANY PEDESTRIAN WAYS AT PATH OF TRAVEL, GRID/OPENINGS IN GRATINGS SHALL BE LIMITED TO 1/2" MAX. IN THE DIRECTION OF TRAFFIC FLOW. IF SUCH CONDITION OCCURS, PROVIDE MANUFACTURER CUTSHEETS OF GRATE PROVIDED.

GATES SERVING THE MEANS OF EGRESS SYSTEM SHALL COMPLY WITH THE REQUIREMENTS OF SECTION 1008. GATES USED AS A COMPONENT IN A MEANS OF EGRESS SHALL CONFORM TO THE APPLICABLE REQUIREMENTS FOR DOORS. PROVIDE LEVER HARDWARE AND KICKPLATE. FIRE AND LIFE SAFETY MAY REQUIRE PANIC HARDWARE FOR EMERGENCY EXITS EVEN WITH THE SIGN. COORDINATE WITH FIRE AND LIFE SAFETY REQUIREMENTS.

DESIGN PROFESSIONAL IN GENERAL RESPONSIBLE CHARGE STATEMENT
 THE POT IDENTIFIED IN THESE CONSTRUCTION DOCUMENTS IS COMPLIANT WITH THE CURRENT APPLICABLE CALIFORNIA BUILDING CODE ACCESSIBILITY PROVISIONS FOR PATH OF TRAVEL REQUIREMENTS FOR ALTERATIONS, ADDITIONS AND STRUCTURAL REPAIRS AS PART OF THE DESIGN OF THIS PROJECT. THE POT WAS EXAMINED AND ANY ELEMENTS, COMPONENTS OR PORTIONS OF THE POT THAT WERE DETERMINED TO BE NON COMPLIANT
 1. HAVE BEEN IDENTIFIED
 2. THE CORRECTIVE WORK NECESSARY TO BRING THEM INTO COMPLIANCE HAS BEEN INCLUDED WITHIN THE SCOPE OF THIS PROJECTS WORK THROUGH DETAILS, DRAWINGS AND SPECIFICATIONS INCORPORATED INTO THESE CONSTRUCTION DOCUMENTS.
 DURING CONSTRUCTION, IF POT ITEMS WITHIN THE SCOPE OF THE PROJECT REPRESENTED AS CODE COMPLIANT ARE FOUND TO BE NON CONFORMING BEYOND REASONABLE CONSTRUCTION TOLERANCES, THEY SHALL BE BROUGHT INTO COMPLIANCE WITH THE CBC AS PART OF THIS PROJECT BY MEANS OF A CONSTRUCTION CHANGE DOCUMENT.

REVISION	DESCRIPTION	DATE	BY
1	PP		
2	TJ	3/23/2020	
3	PP		
4	PP		
5	PP		
6	PP		
7	PP		
8	PP		
9	PP		
10	PP		
11	PP		
12	PP		
13	PP		
14	PP		
15	PP		
16	PP		
17	PP		
18	PP		
19	PP		
20	PP		
21	PP		
22	PP		
23	PP		
24	PP		
25	PP		
26	PP		
27	PP		
28	PP		
29	PP		
30	PP		
31	PP		
32	PP		
33	PP		
34	PP		
35	PP		
36	PP		
37	PP		
38	PP		
39	PP		
40	PP		
41	PP		
42	PP		
43	PP		
44	PP		
45	PP		
46	PP		
47	PP		
48	PP		
49	PP		
50	PP		
51	PP		
52	PP		
53	PP		
54	PP		
55	PP		
56	PP		
57	PP		
58	PP		
59	PP		
60	PP		
61	PP		
62	PP		
63	PP		
64	PP		
65	PP		
66	PP		
67	PP		
68	PP		
69	PP		
70	PP		
71	PP		
72	PP		
73	PP		
74	PP		
75	PP		
76	PP		
77	PP		
78	PP		
79	PP		
80	PP		
81	PP		
82	PP		
83	PP		
84	PP		
85	PP		
86	PP		
87	PP		
88	PP		
89	PP		
90	PP		
91	PP		
92	PP		
93	PP		
94	PP		
95	PP		
96	PP		
97	PP		
98	PP		
99	PP		
100	PP		



KRUGER BENSON ZIEMER ARCHITECTS, INC. AIA
 1189 FELICIA ST., SUITE 100A VENTURA, CA 93001
 TELEPHONE (805) 650-1033

TODD A. JESPERSEN, AIA
 PRINCIPAL ARCHITECT
 JONATHAN D. LEE
 ARCHITECTURAL ASSISTANT

All ideas, design arrangements and plans indicated or represented by this drawing are owned by and are the property of Kruger-Benson-Ziemer, AIA, architects, and were created, evolved and developed for use on, and in connection with, the specified project. None of such ideas, design, arrangements or plans shall be used by or disclosed to any person, firm or corporation for any purpose whatsoever without the written permission of Kruger-Benson-Ziemer.

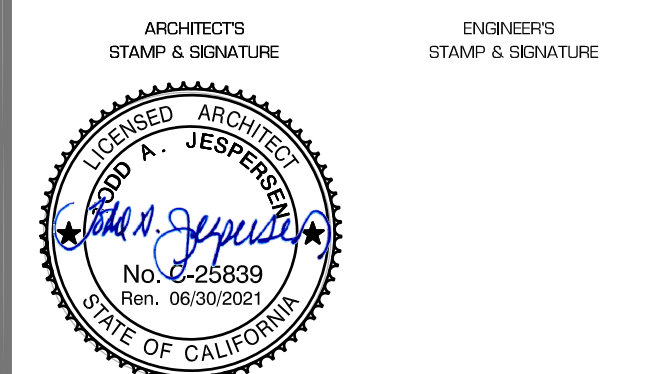

CONSULTANT INFORMATION

REVISION	DESCRIPTION	DATE	BY
1	DRAWN	PP	
2	CHECKED	TJ	
3	DATE	3/23/2020	
4	JOB. NO.	19001	
5	DSA #03-120196	FILE: 56-H4 P/N: 72546-88	
6	SHEET	ENLARGED GATE PLANS	
7	TITLE		

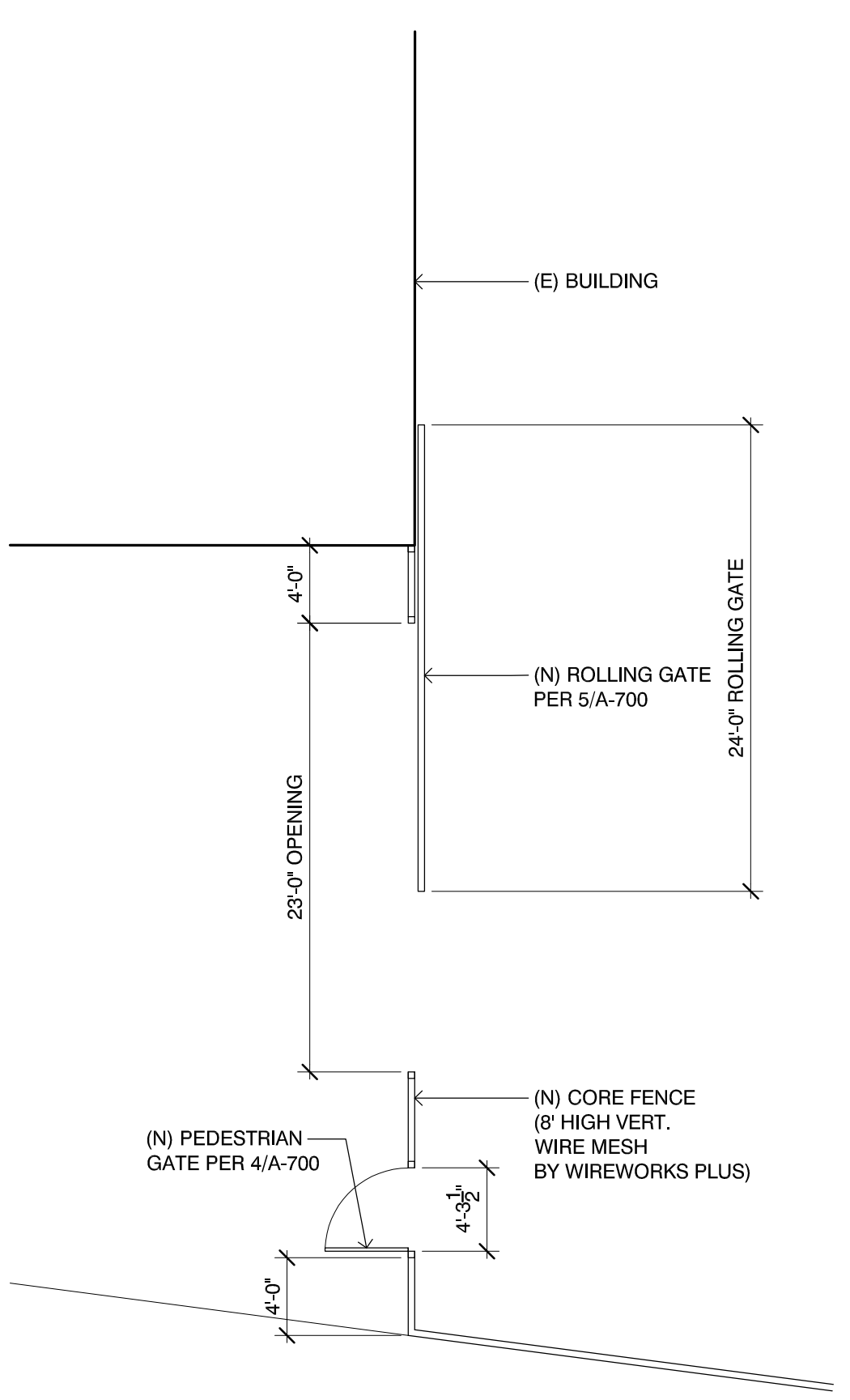

10 ACHS Gate 10 Enlarged Plan
 SCALE: 1/8" = 1'-0"

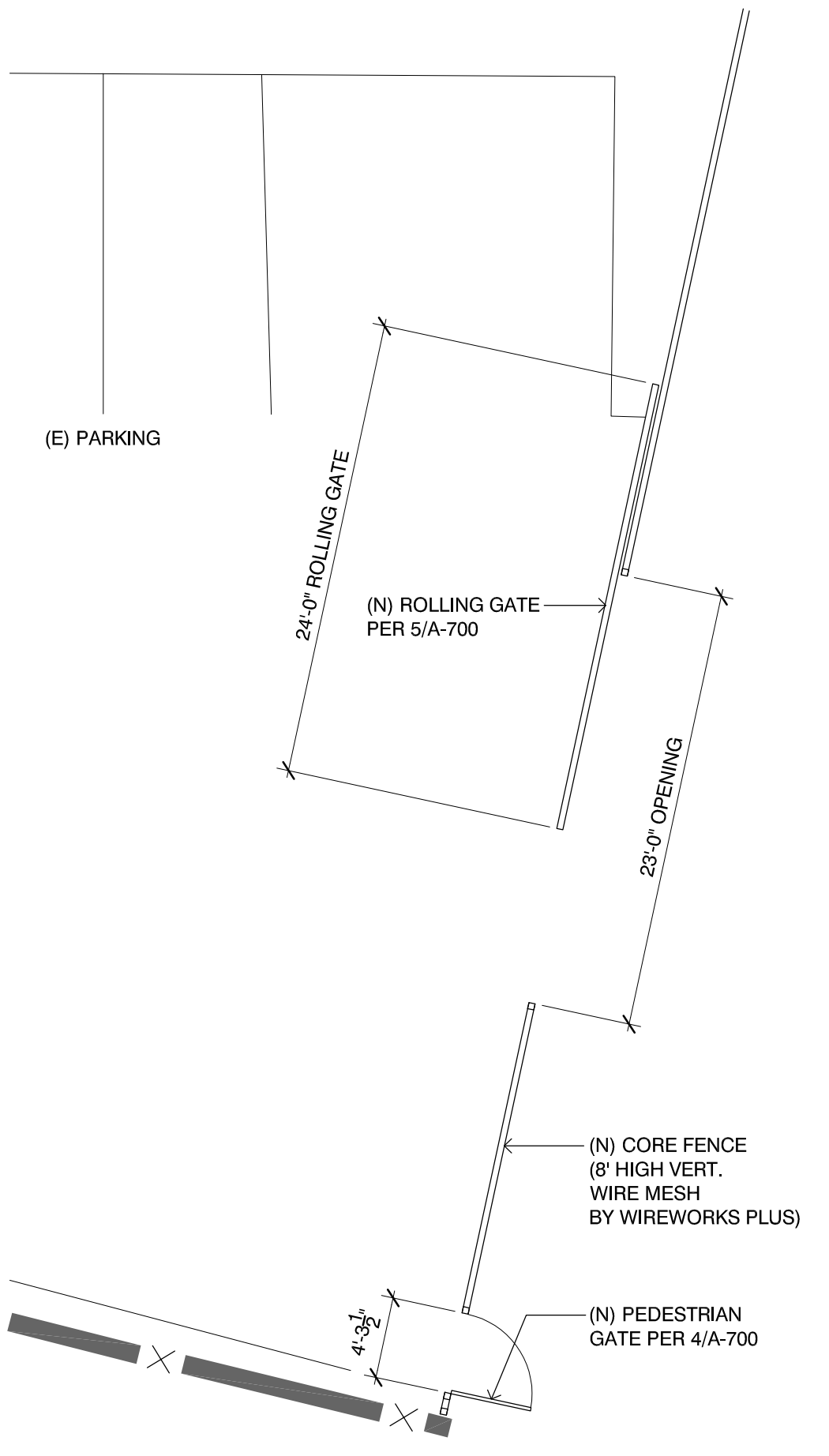

11 ACHS Gate 11 Enlarged Plan
 SCALE: 1/8" = 1'-0"

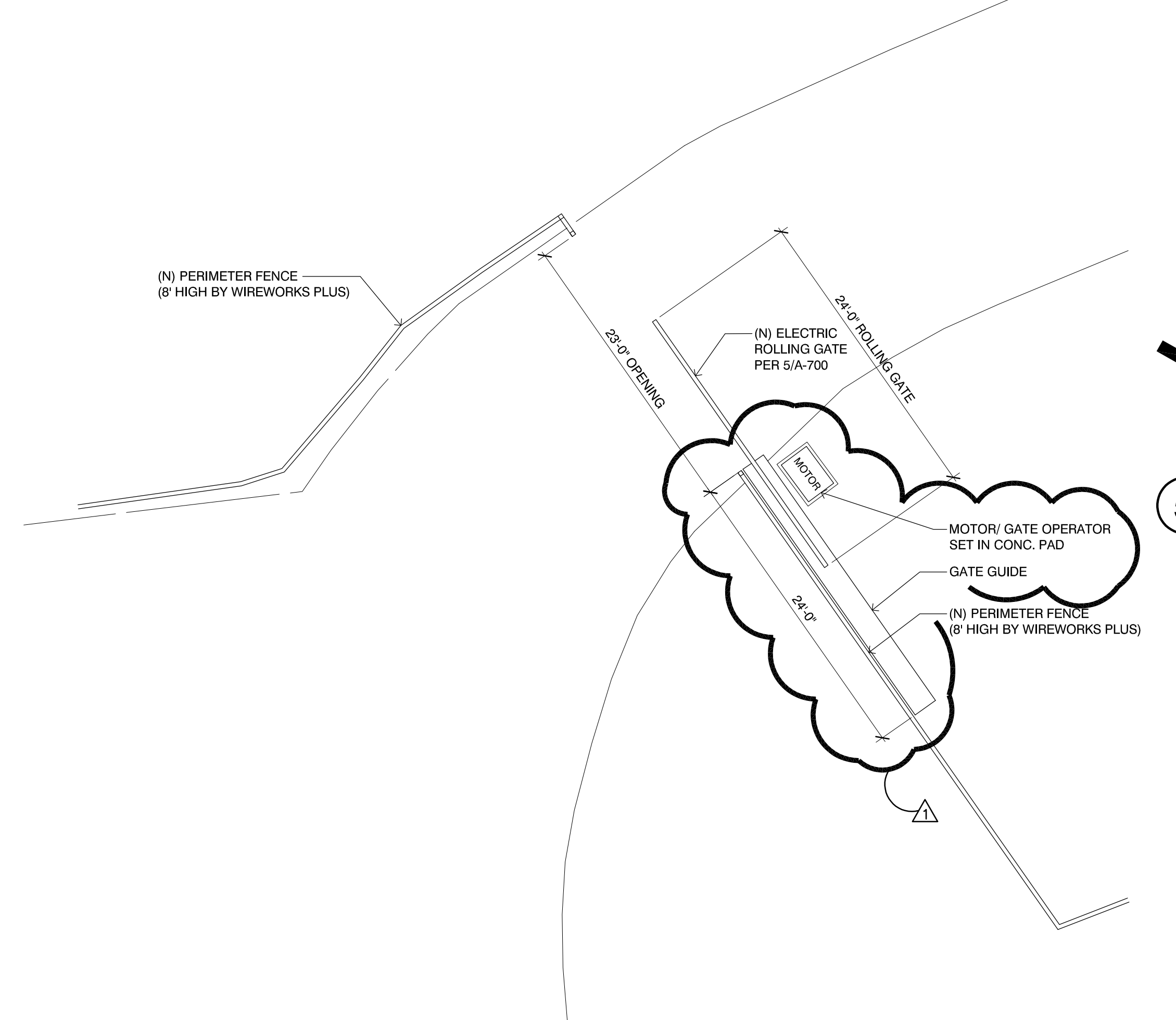

5 ACHS Gate 05 Enlarged Plan
 SCALE: 1/8" = 1'-0"

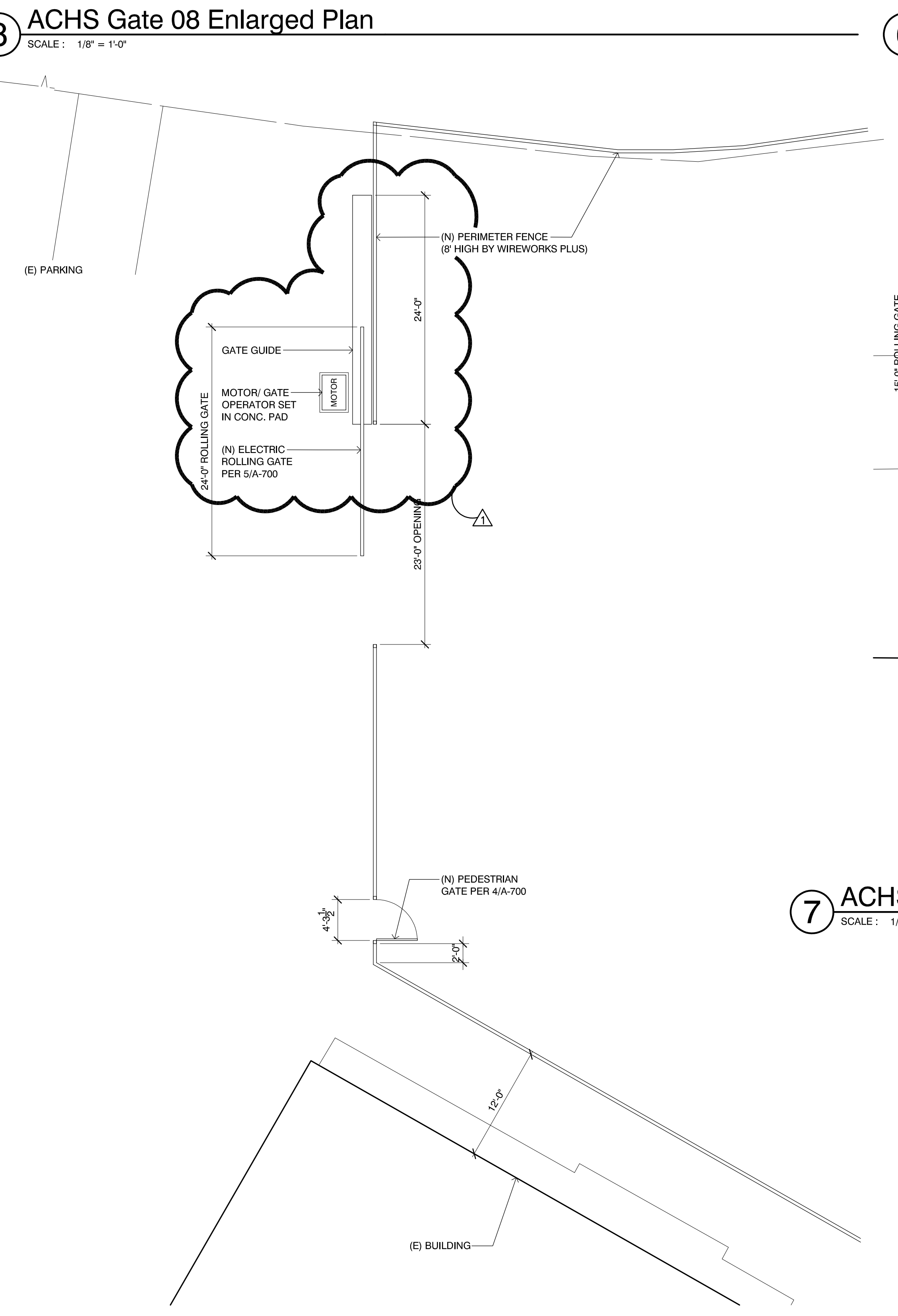

9 ACHS Gate 09 Enlarged Plan
 SCALE: 1/8" = 1'-0"

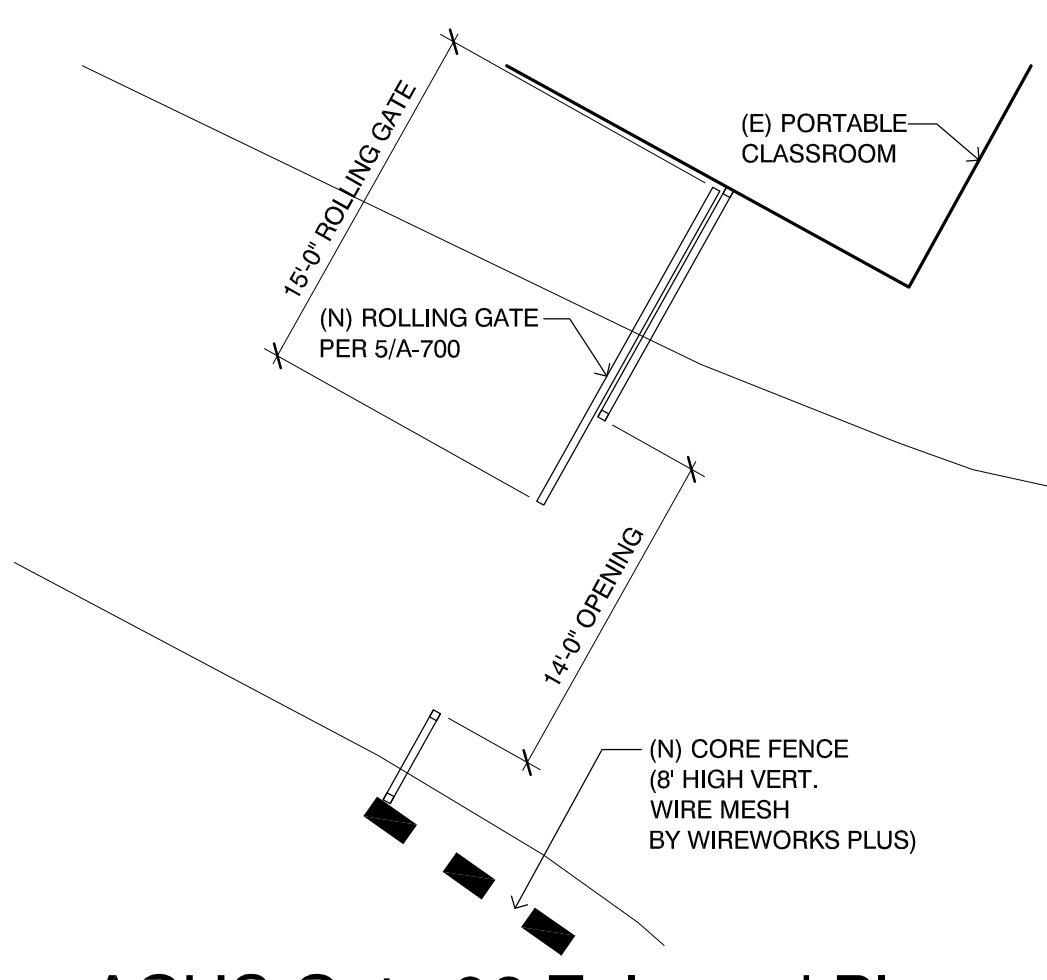

6 ACHS Gate 06 Enlarged Plan
 SCALE: 1/8" = 1'-0"

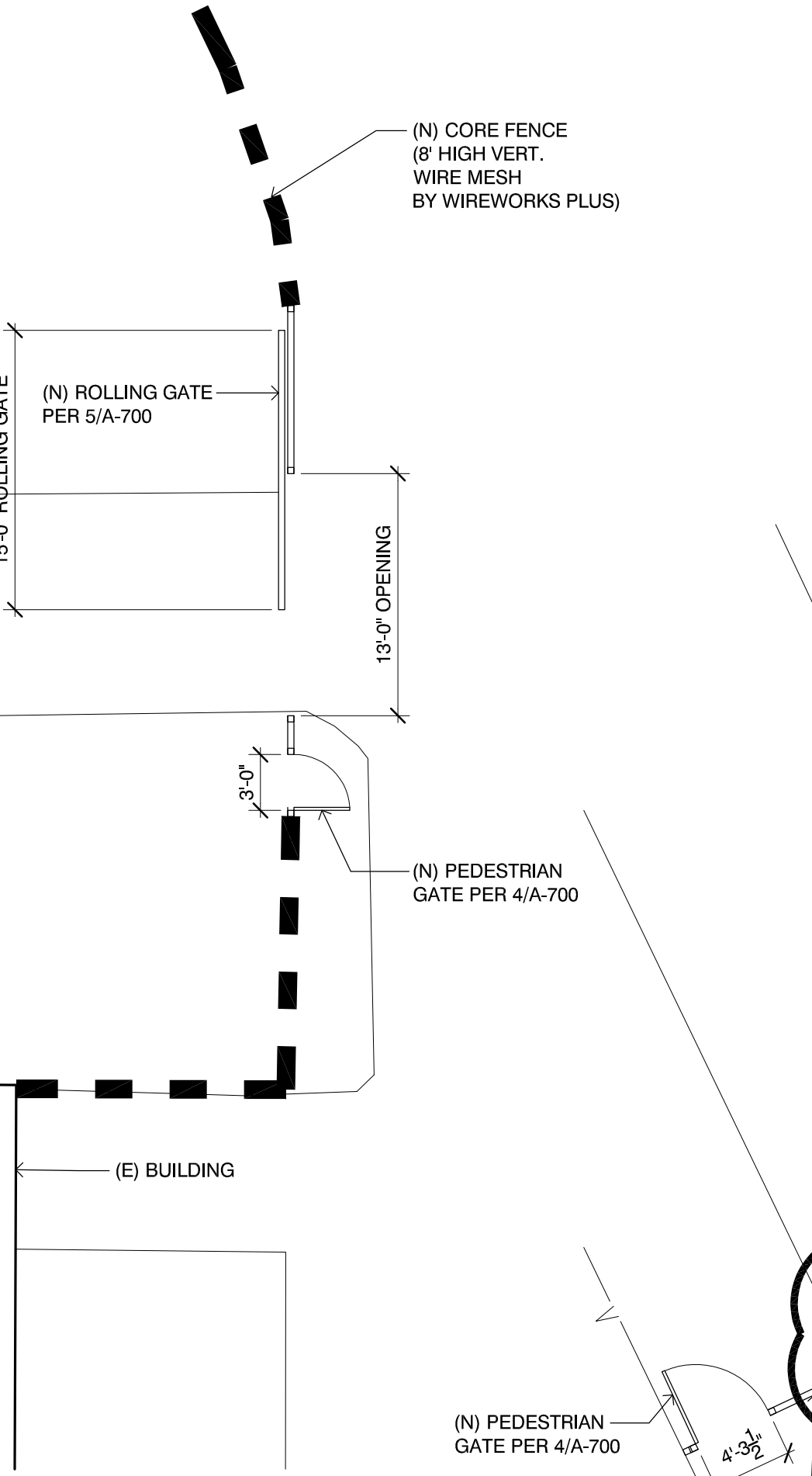

7 ACHS Gate 07 Enlarged Plan
 SCALE: 1/8" = 1'-0"

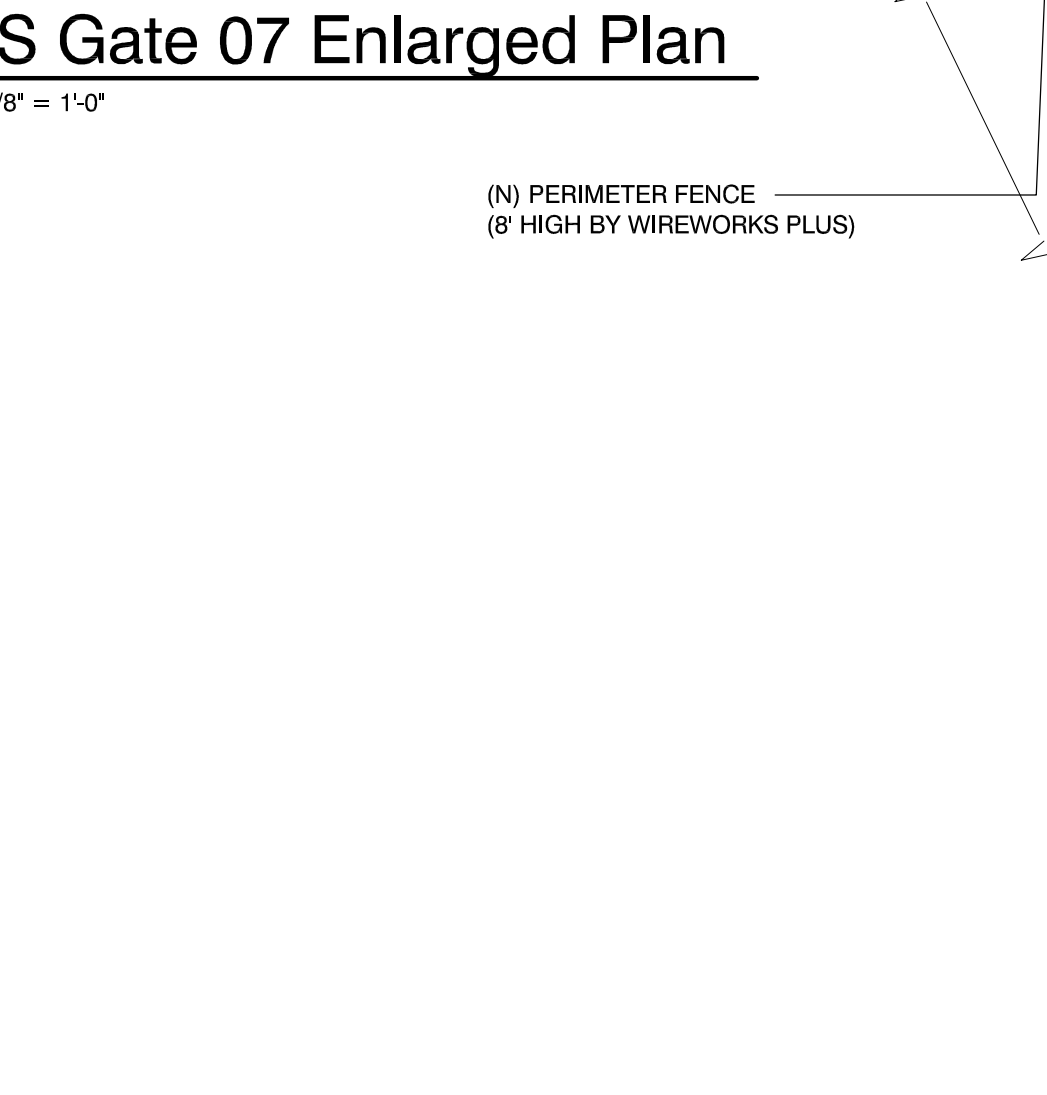

3 ACHS Gate 03 Enlarged Plan
 SCALE: 1/8" = 1'-0"

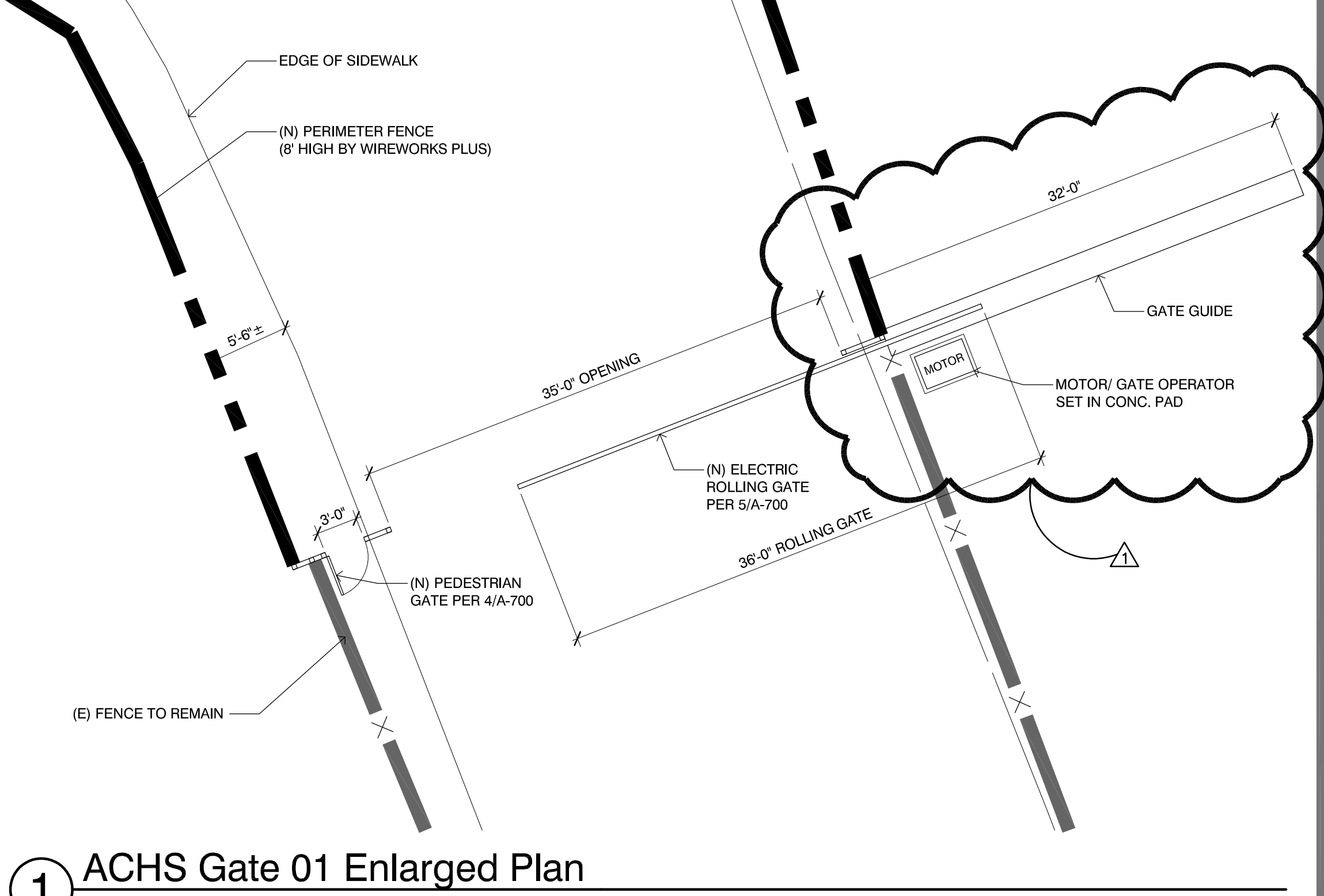

1 ACHS Gate 01 Enlarged Plan
 SCALE: 1/8" = 1'-0"

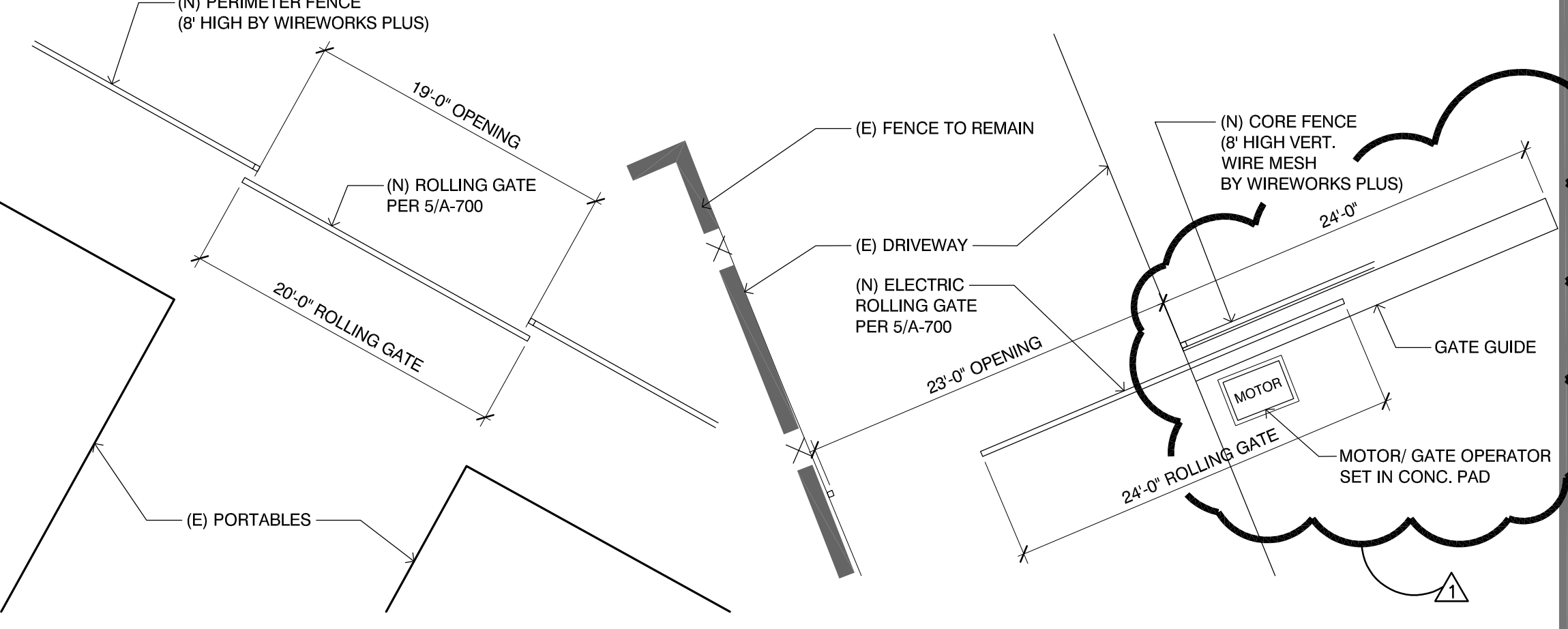

2 ACHS Gate 02 Enlarged Plan
 SCALE: 1/8" = 1'-0"

4 ACHS Gate 04 Enlarged Plan
 SCALE: 1/8" = 1'-0"

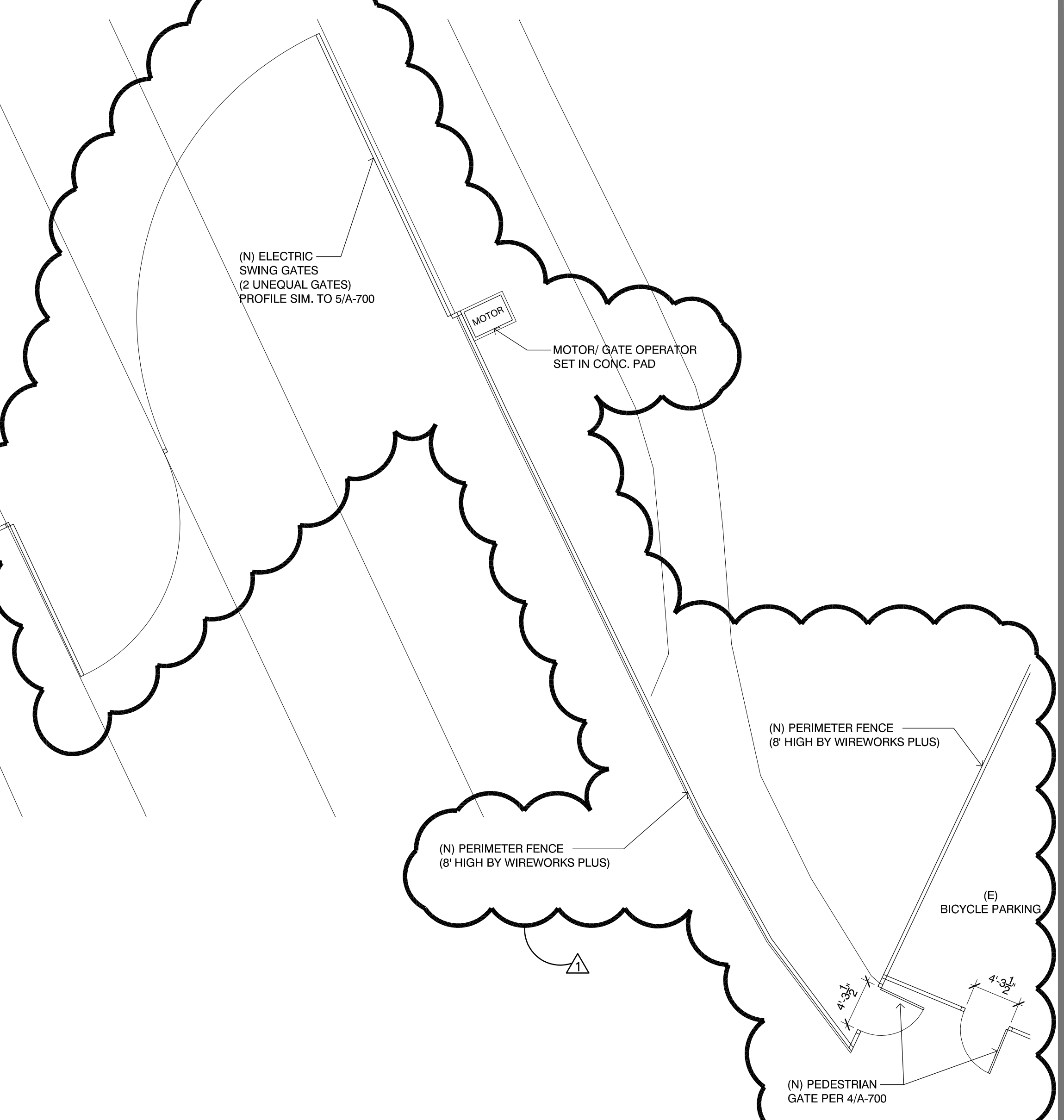

△	-	-/-	XX
△	-	-/-	XX
△	-	-/-	XX
△	-	-/-	XX
△	BID ADDENDUM 2	4/21/20	XX

WIND LOADING CAPABILITIES

FENCE HEIGHT	RAIL LENGTH	POST SIZE	WIND LOAD CAPACITY FACTOR (WLF)		TYPICAL WIND LOAD CAPACITY (WLP)	
			AEGIS II	AEGIS PLUS	AEGIS II	AEGIS PLUS
4'	8'	2" x 12 ga.	122.8	127.0	235.0	244.0
	8'	2" x 12 ga.	122.8	127.0	235.0	244.0
	8'	2" x 12 ga.	122.8	127.0	235.0	244.0
5'	8'	2" x 12 ga.	122.8	127.0	235.0	244.0
	8'	2" x 12 ga.	122.8	127.0	235.0	244.0
	8'	2" x 12 ga.	122.8	127.0	235.0	244.0
6'	8'	2" x 12 ga.	122.8	127.0	235.0	244.0
	8'	2" x 12 ga.	122.8	127.0	235.0	244.0
	8'	2" x 12 ga.	122.8	127.0	235.0	244.0
7'	8'	2" x 12 ga.	122.8	127.0	235.0	244.0
	8'	2" x 12 ga.	122.8	127.0	235.0	244.0
	8'	2" x 12 ga.	122.8	127.0	235.0	244.0
8'	8'	2" x 12 ga.	122.8	127.0	235.0	244.0
	8'	2" x 12 ga.	122.8	127.0	235.0	244.0
	8'	2" x 12 ga.	122.8	127.0	235.0	244.0
10'	8'	2" x 12 ga.	122.8	127.0	235.0	244.0
	8'	2" x 12 ga.	122.8	127.0	235.0	244.0
	8'	2" x 12 ga.	122.8	127.0	235.0	244.0

WLP values shown are provided for information only. They are calculated using ASCE 7-10, "American Society of Civil Engineers Minimum Design Loads for Buildings and Other Structures" Exposure Category C open terrain with standard construction having heights generally less than 30 feet. Based on just acting wind. Do not combine with other loads. Do not assume to be of mid-range strength and construction. Some specified exposed conditions such as unobstructed building corners, elevation of installation, post location, design, soil strength, etc. may change from project to project. A structural engineering evaluation, under applicable requirements and conditions, should be performed. Consult your American Service Representative for an estimate on Engineering Analysis and P.L. Certification.

15 Wind Loading Capabilities

SCALE: N.T.S.

WIREWORKS PLUS® CONSTRUCTION SPECIFICATION 32 31 00

COMMERCIAL WELDED WIRE ARCHITECTURAL FENCE SYSTEM

TABLE 1	MINIMUM SIZES FOR WIREWORKS PLUS SYSTEMS	
	FENCE POSTS	RAILS
up to 4' height	2" x 12 ga.	2" x 12 ga.
up to 6' height	2" x 12 ga.	2" x 12 ga.
up to 8' height	2" x 12 ga.	2" x 12 ga.
up to 10' height	2" x 12 ga.	2" x 12 ga.
up to 12' height	2" x 12 ga.	2" x 12 ga.
up to 14' height	2" x 12 ga.	2" x 12 ga.
up to 16' height	2" x 12 ga.	2" x 12 ga.
up to 18' height	2" x 12 ga.	2" x 12 ga.

TABLE 2	COATING PERFORMANCE REQUIREMENTS	
	ASTM TEST METHOD	PERFORMANCE REQUIREMENTS
ADHESION	D3359 - METHOD B	Adhesion (detachment of coating) over 90% of test area (one end and both air feet).
CORROSION RESISTANCE	B117, B714, B954	Corrosion resistance over 1,000 hours (detached per 0.125). Failure mode is penetration of 0.005" coating from surface or surface delamination.
IMPACT RESISTANCE	D2794	Impact resistance over 80" ft. (normal impact using 0.625" ball).
WEATHERING RESISTANCE	B622 D244, D223 (MFT method)	Weathering resistance over 1,000 hours (failure mode is 60% loss of gloss or color variation of more than 3 Delta E color units).

TABLE 3	WIREWORKS PLUS POST SPACING BY RAIL TYPE	
	SPACING	WIREWORKS PLUS
POST SIZE	2"	24"
POST SETTINGS	90°	90°

WIREWORKS PLUS® V-FOLD BRACKETS

DESCRIPTION	SIZE	ITEM NUMBER	BOX QTY	WEIGHT EA
U-BOLT	2"	UB@2R	50	.5 lbs
U-BOLT BRACKET FOR LINE / END POST	2.5"	UB@2.5R	50	.8 lbs
CORNER / GATE BRACKET	3"	UB@3R	50	.9 lbs
FASTENER SOCKET	N/A	W@GSSR	50	.9 lbs

@ = COLOR OPTIONS AVAILABLE | B = Black | G = Green | N = Bronze | S = Sand
 T = Tube Brown | W = White
 ○ = NON-STOCKED PRODUCT
 For details, see Ameristar's Sales Policy in the catalog guide.

16 Wireworks Plus Data

SCALE: N.T.S.

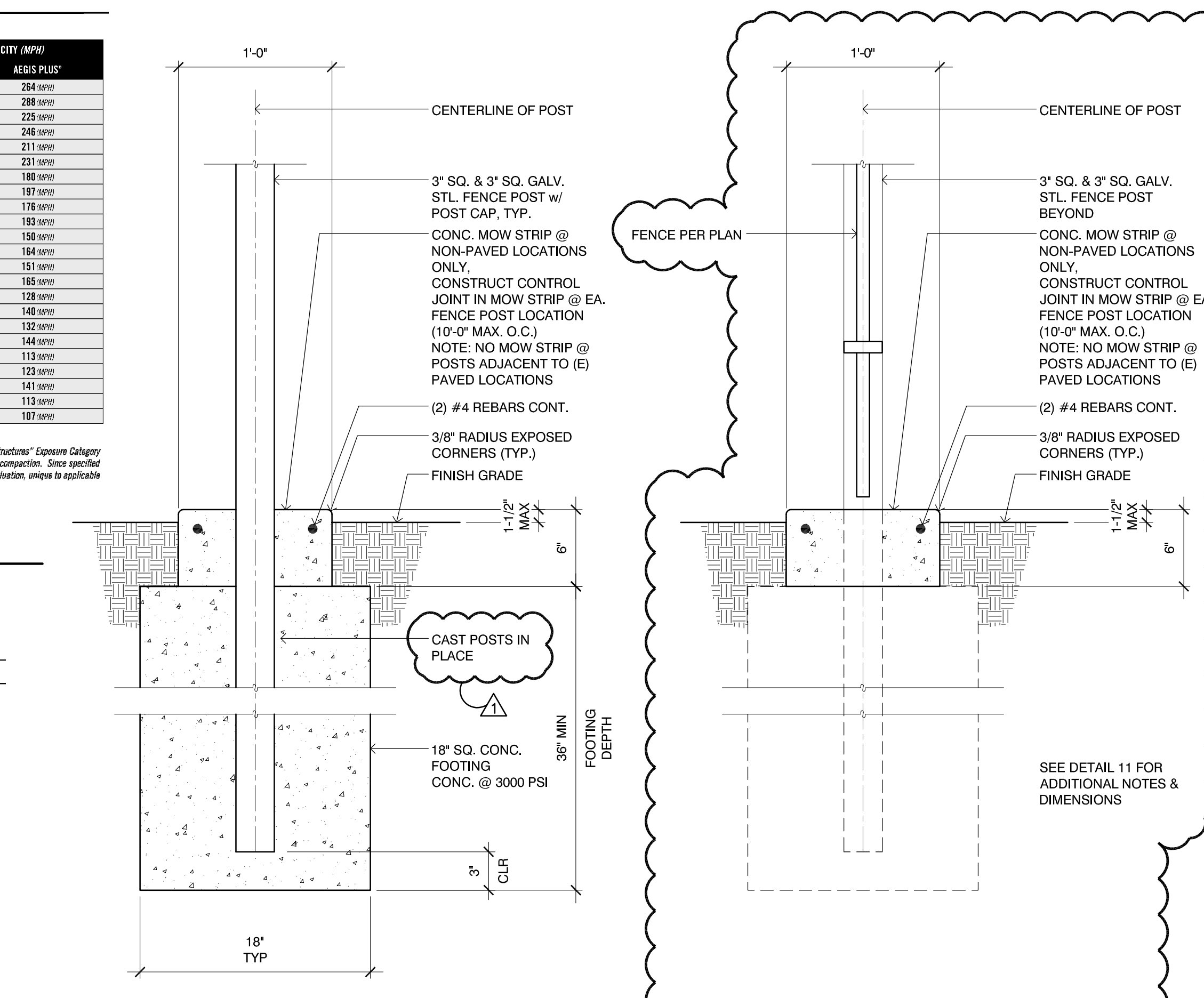

11 Typ. Fence Post Footing SCALE: 1-1/2" = 1'-0"

11a Typ. Fence Between Posts SCALE: 1-1/2" = 1'-0"

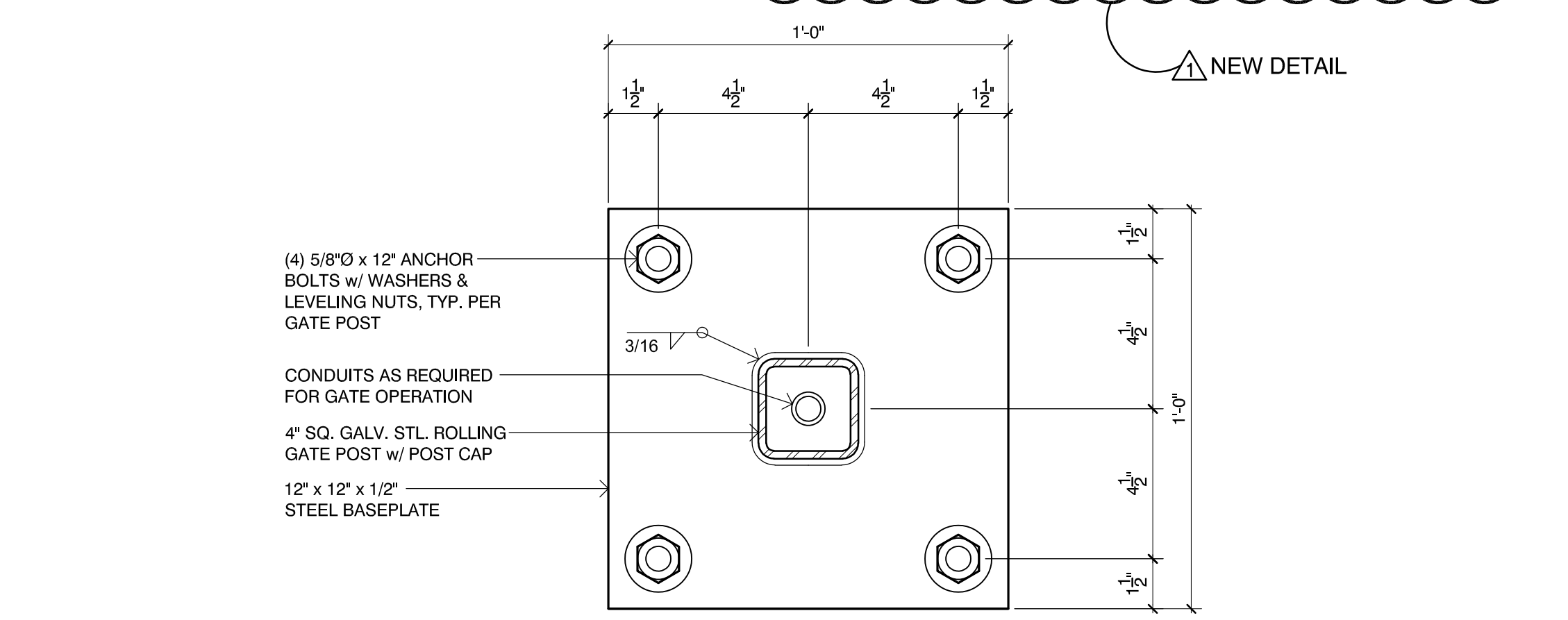

12 Typ. Base Plate @ Gate Posts SCALE: 3" = 1'-0"

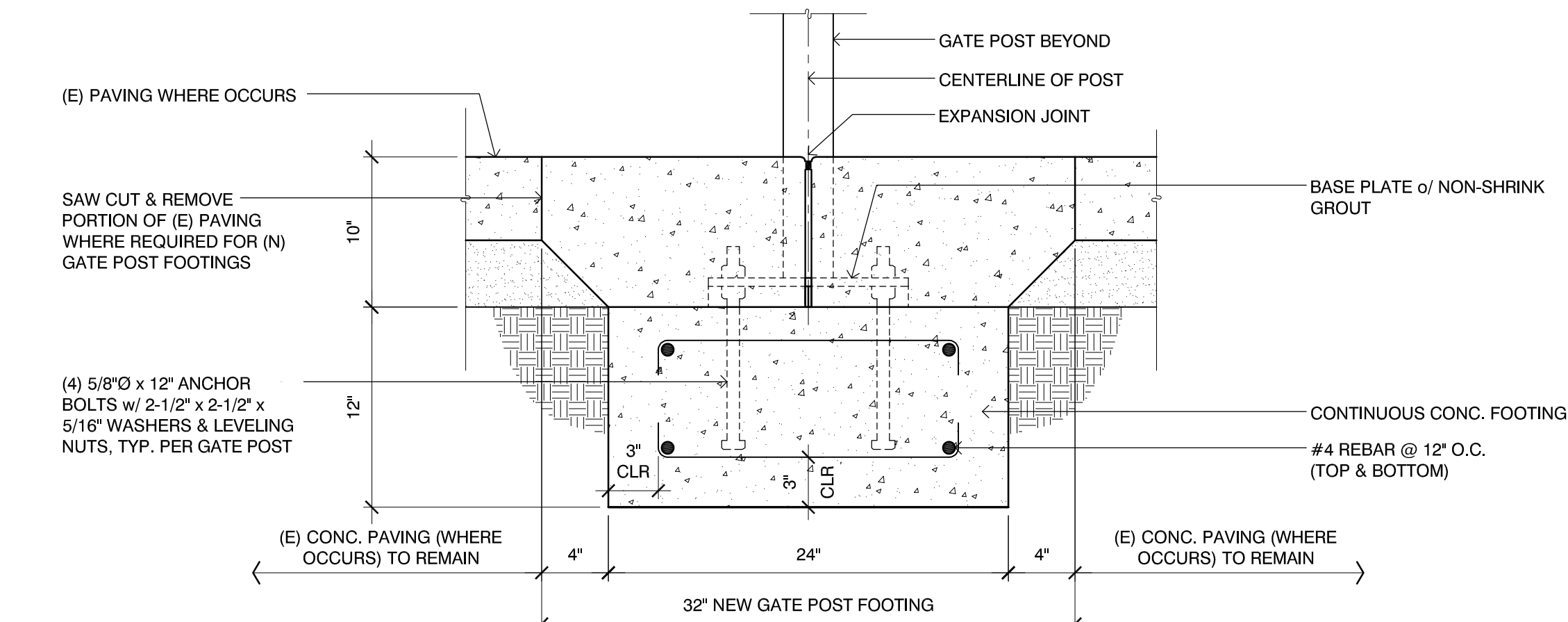

13 Typ. Gate Post Footing SCALE: 1-1/2" = 1'-0"

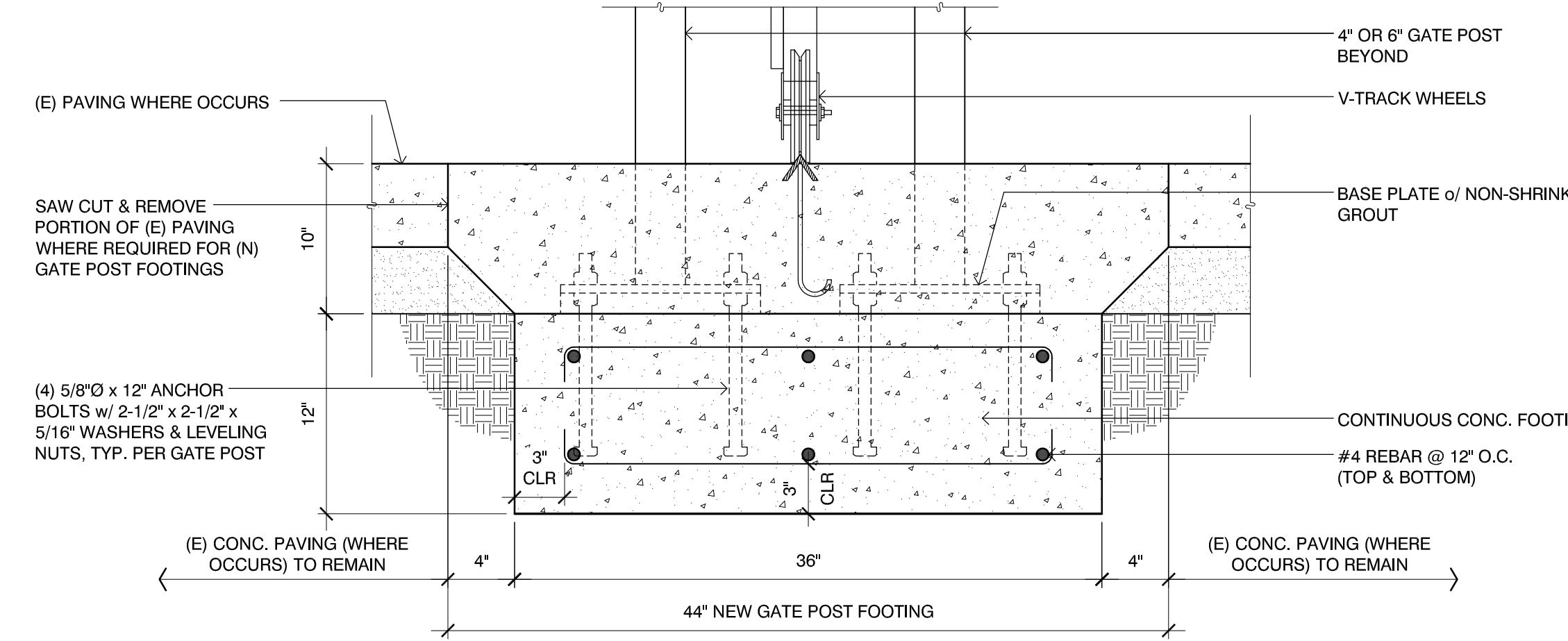

14 Gate Post Footing SCALE: 1-1/2" = 1'-0"

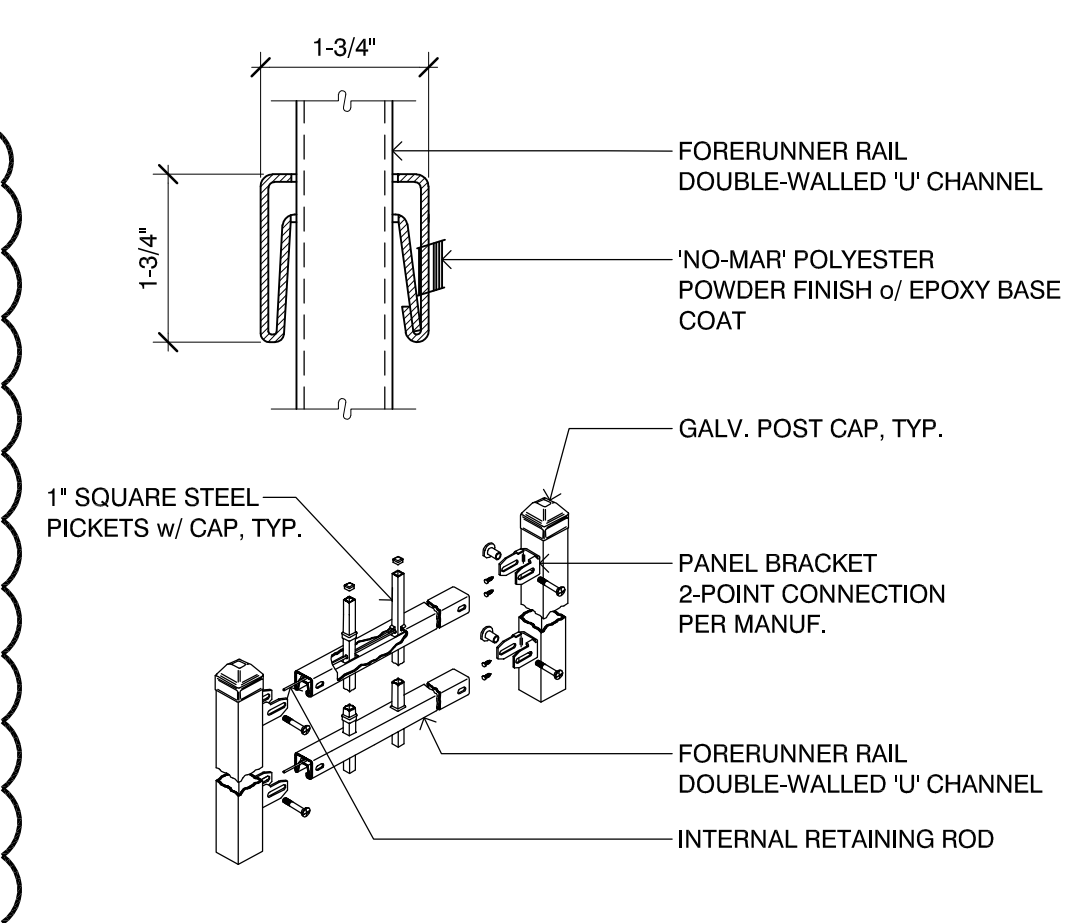

6 Fence Details SCALE: N.T.S.

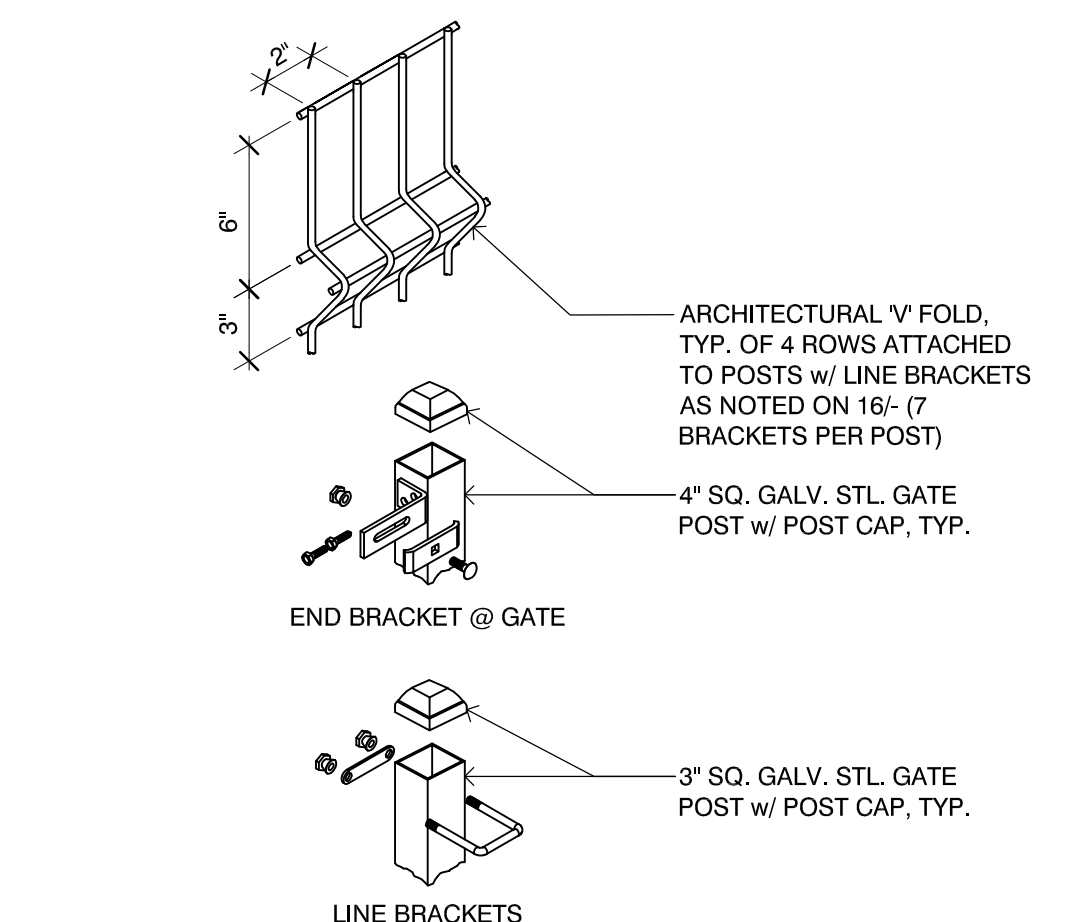

7 Fence Details SCALE: N.T.S.

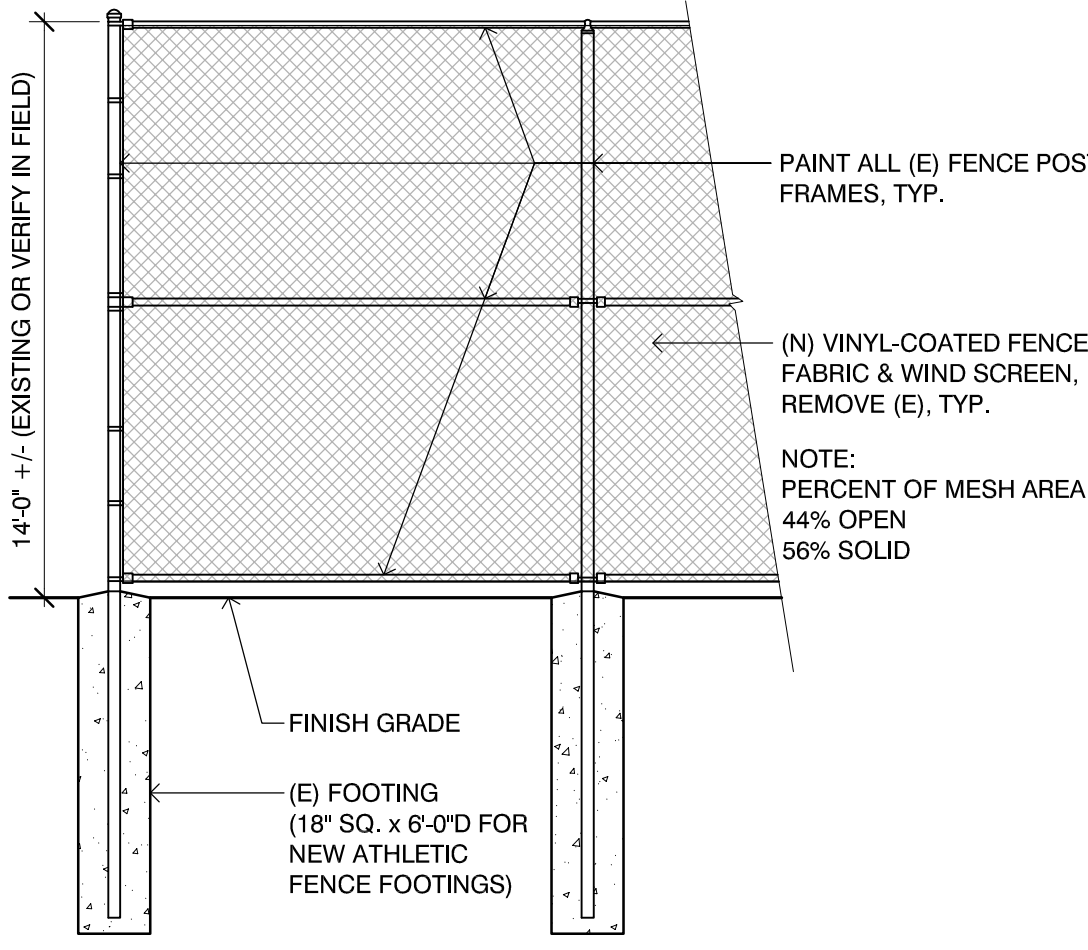

8 Athletic Fence Detail SCALE: N.T.S.

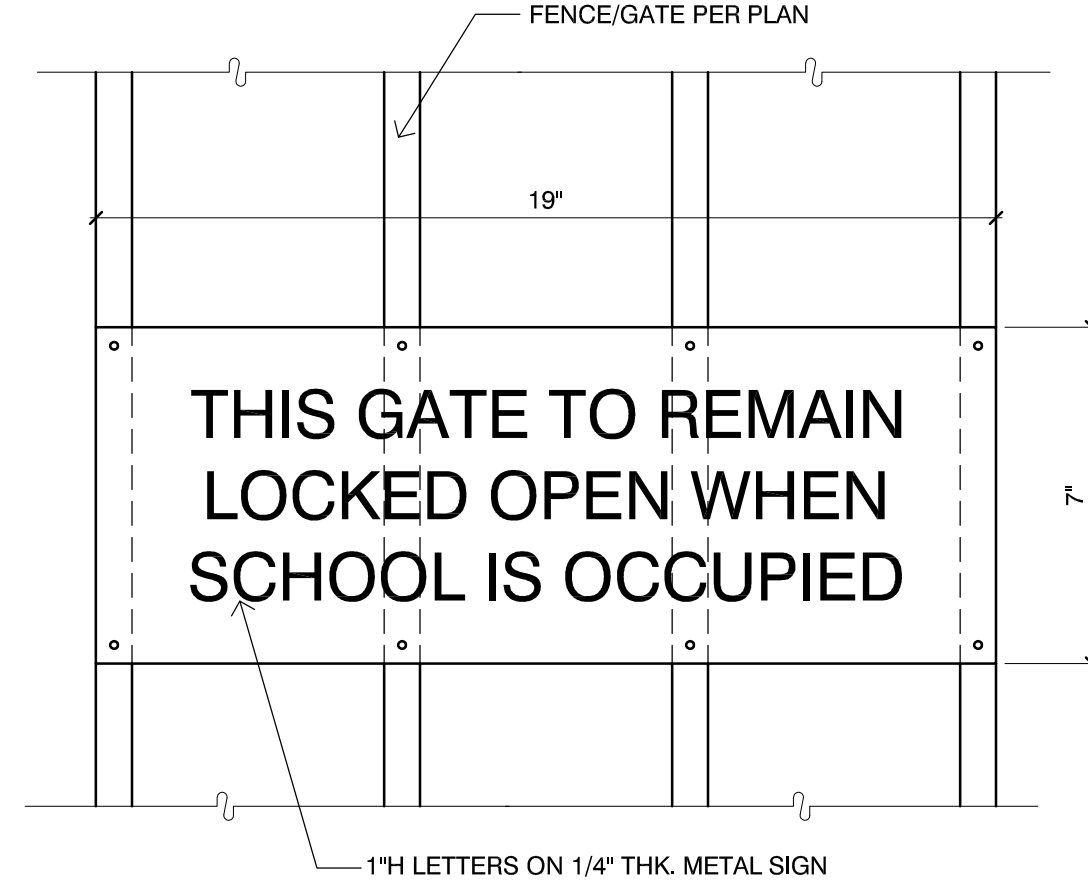

9 Typ. Gate Sign SCALE: 3" = 1'-0"



10 Typ. Gate Sign SCALE: 3" = 1'-0"

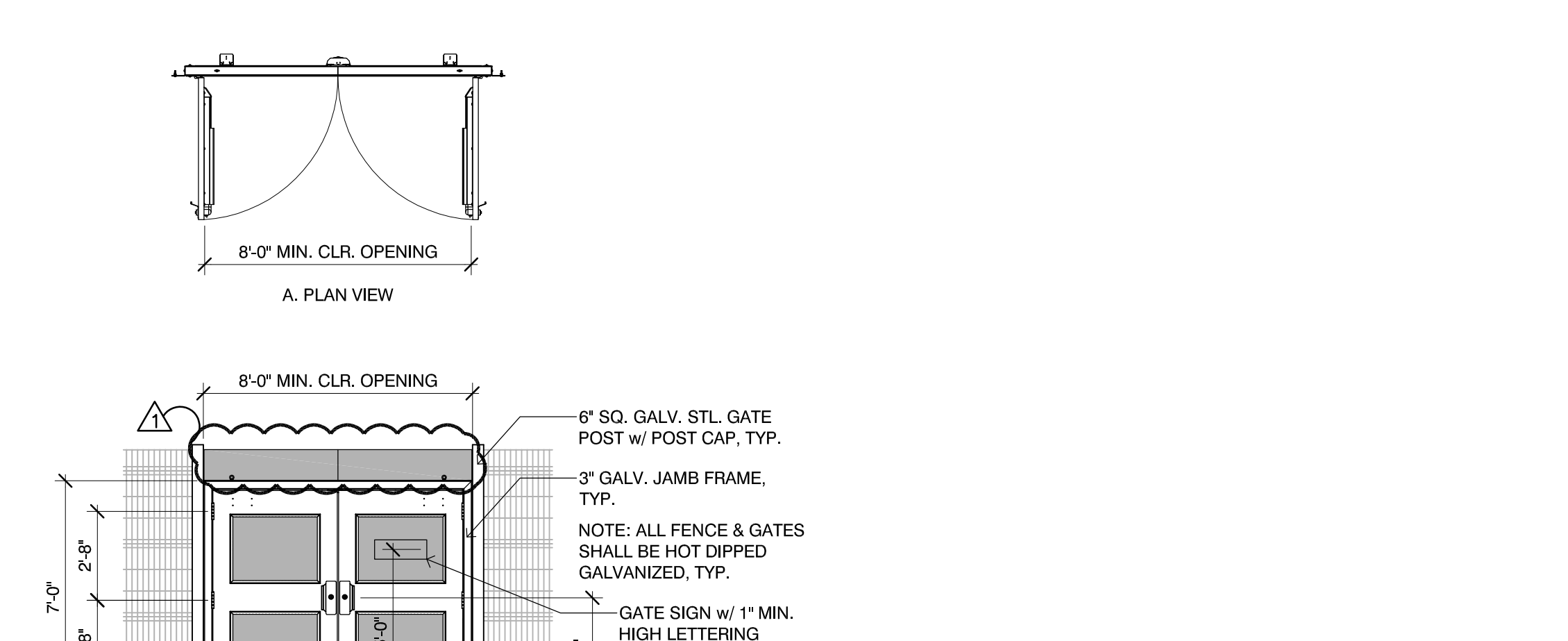

3 Gate - Double Door SCALE: 1/4" = 1'-0"

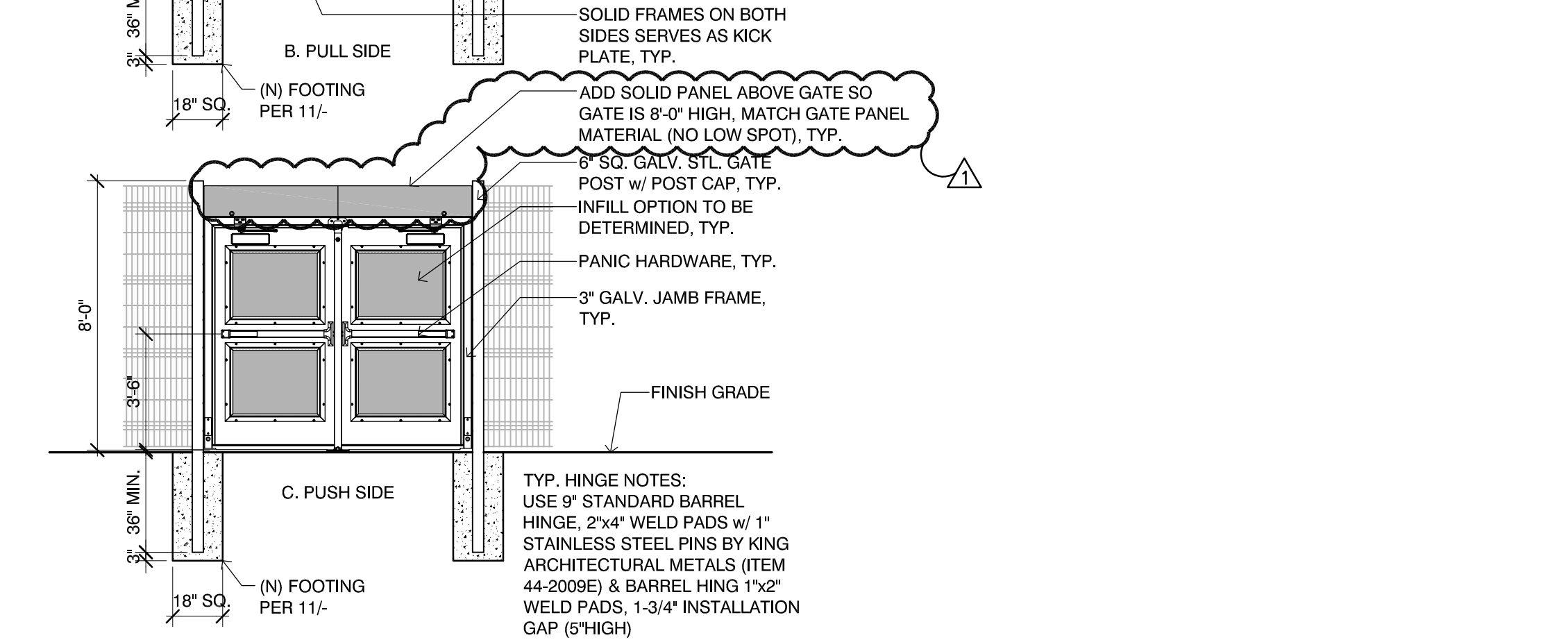

3 Gate - Double Door SCALE: 1/4" = 1'-0"

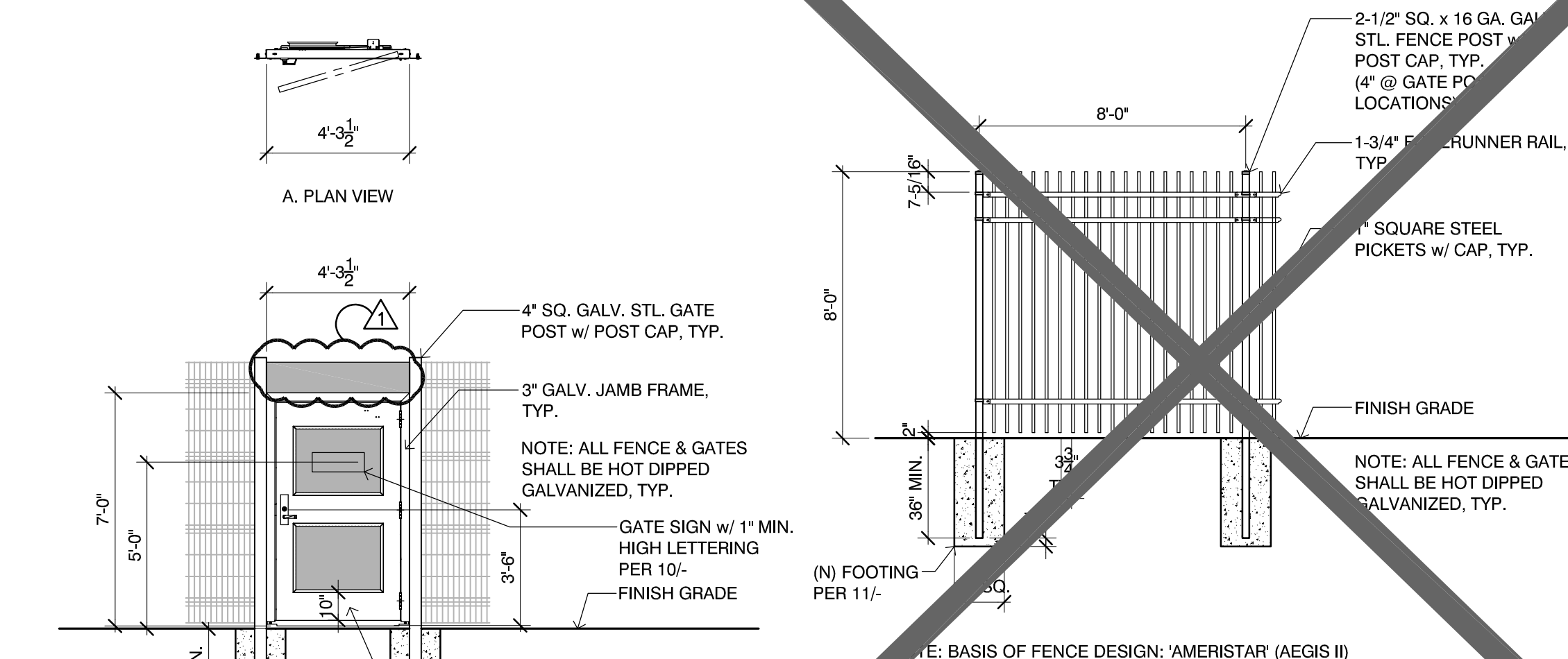

8 Athletic Fence Detail SCALE: N.T.S.

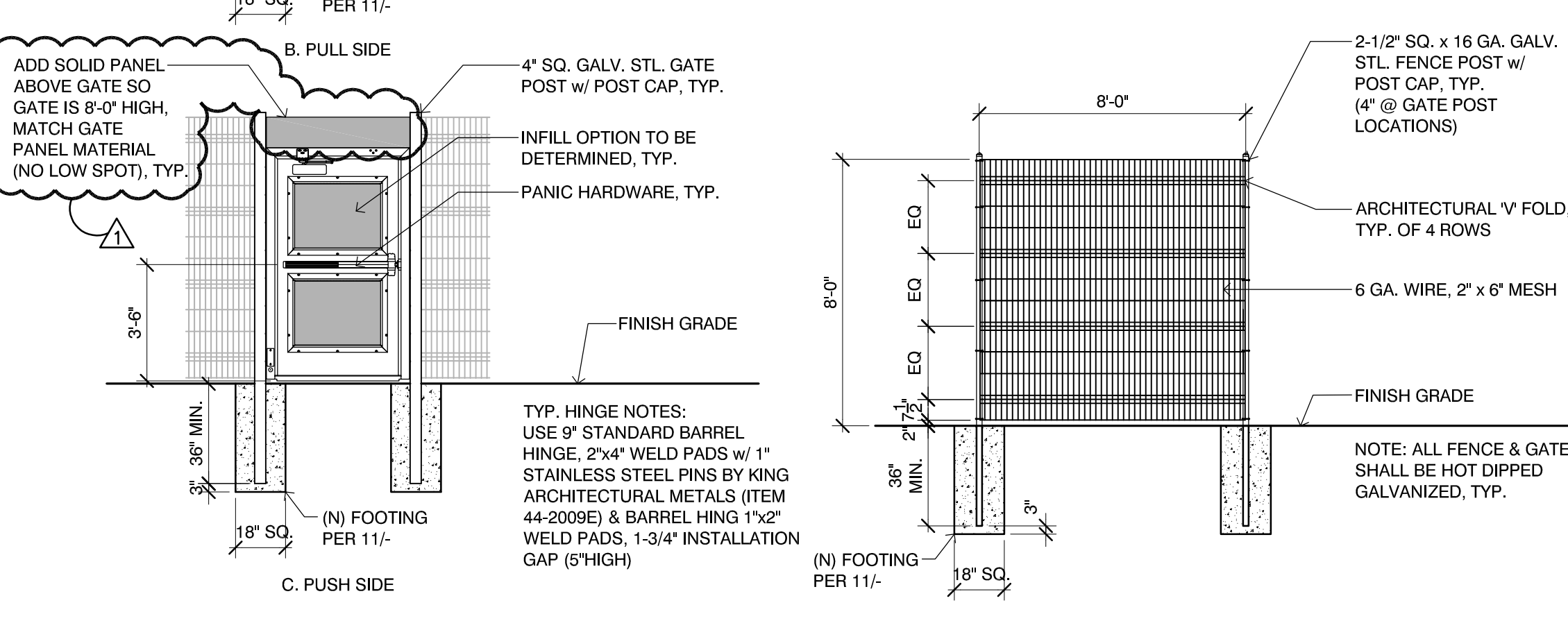

4 Gate - Single Door SCALE: 1/4" = 1'-0"

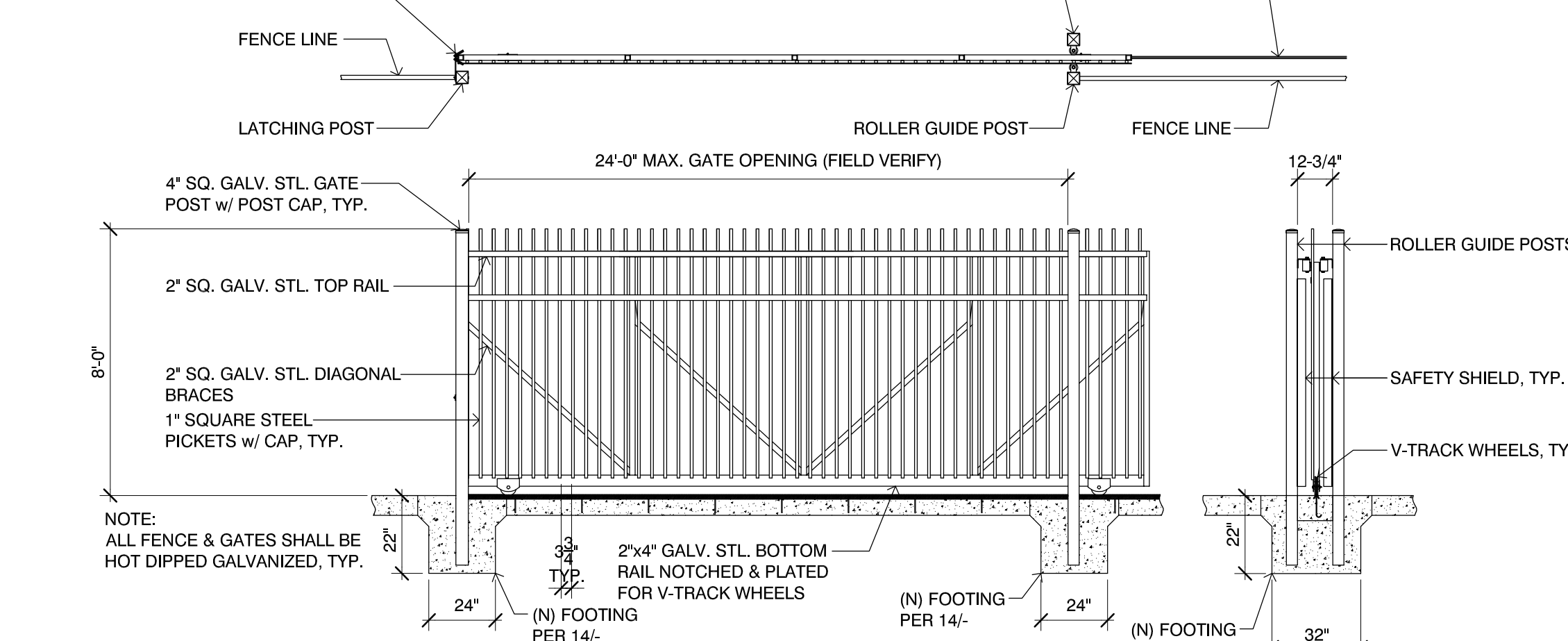

5 Rolling Gate SCALE: 1/4" = 1'-0"

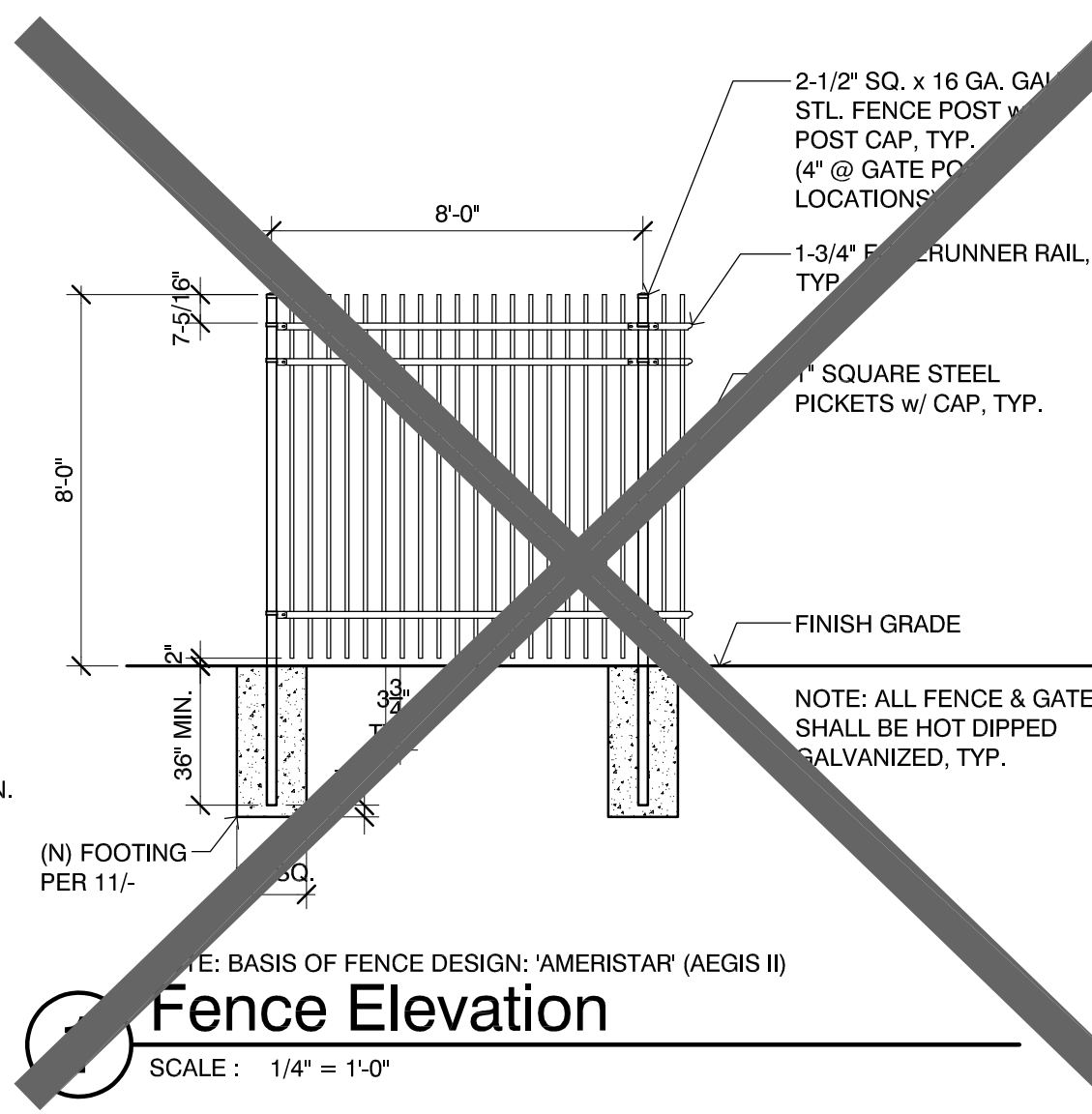

Fence Elevation SCALE: 1/4" = 1'-0"

OXNARD UNION HIGH SCHOOL DISTRICT
ADOLFO CAMARILLO HIGH SCHOOL
4660 MISSION OAKS BLVD., CAMARILLO, CA 93012
CAMPUS SECURITY FENCING



KRUGER BENSON ZIEMER ARCHITECTS, INC. AIA
1189 FELIXDA ST., SUITE 100A VENTURA, CA 93001
TELEPHONE (805) 650-1353
TODD A. JESPERSEN, AIA
PRINCIPAL ARCHITECT
JONATHAN D. LEE
ARCHITECTURAL ASSISTANT

All ideas, design arrangements and plans indicated or represented by this drawing are owned by and are the property of Kruger-Benson-Ziemer, AIA, architects, and were created, revised and developed for use on, and in connection with, the specified project. None of such ideas, designs, arrangements or plans shall be used by or disclosed to any person, firm or corporation for any purpose whatsoever without the written permission of Kruger-Benson-Ziemer.

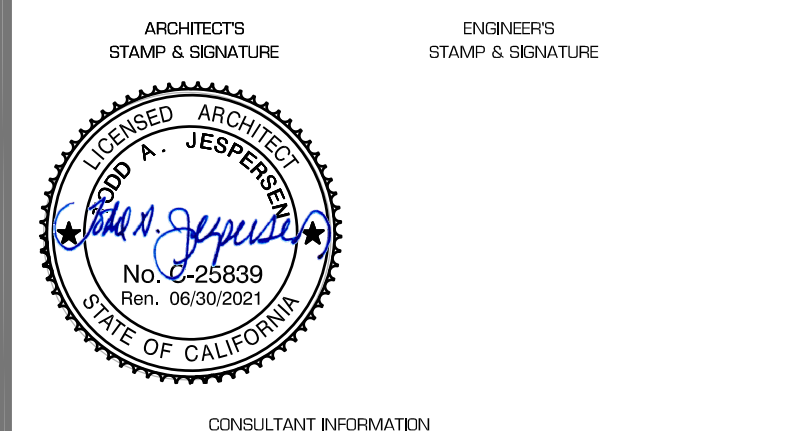

ARCHITECTS STAMP & SIGNATURE ENGINEERS STAMP & SIGNATURE

REVISION	DESCRIPTION	DATE	BY
CHECKED	TJ		
DATE	3/23/2020		
JOB. NO.	19001		
DSA #03-120195	FILE: 56-H4 PTH: 72546-88		
SHEET	TYPICAL DETAILS		
TITLE			

A-700